

ART. 28 Regolatore di flusso unidirezionale per valvola
Unidirectional flow regulator for valve

CODICE	ØD	G	ØA	H	L1	L		
2804M5	4	M5	1,9	4,0	19,5	21,5	10	25
280418	4	1/8	5,5	5,5	21,1	34,0	14	25
280618	6	1/8	5,5	5,5	24,3	34,0	14	25
280614	6	1/4	6,0	6,5	25,5	42,0	17	25
280818	8	1/8	5,5	5,5	24,8	34,0	14	25
280814	8	1/4	6,0	6,5	26,5	42,0	17	25
280838	8	3/8	8,0	7,5	28,0	52,0	20	10
281014	10	1/4	6,0	6,5	28,4	42,0	17	25
281038	10	3/8	8,0	7,5	29,9	52,0	20	10
281238	12	3/8	8,0	7,5	31,4	52,0	20	10

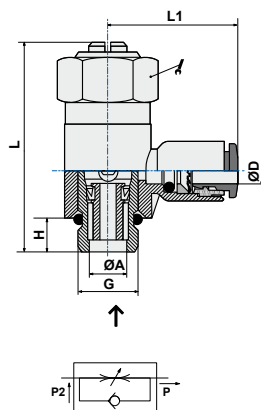

ART. 29 Regolatore di flusso unidirezionale per cilindro
Unidirectional flow regulator for cylinder

CODICE	ØD	G	ØA	H	L1	L		
2904M5	4	M5	1,9	4,0	19,5	21,5	10	25
290418	4	1/8	5,0	5,5	21,1	34,0	14	25
2906M5	6	M5	1,9	4,0	22,5	21,5	10	25
290618	6	1/8	5,0	5,5	24,3	34,0	14	25
290614	6	1/4	6,0	6,5	25,5	42,0	17	25
290818	8	1/8	5,0	5,5	24,8	34,0	14	25
290818	8	1/4	6,0	6,5	26,5	42,0	17	25
290838	8	3/8	6,5	7,5	28,0	52,0	20	10
291014	10	1/4	6,0	6,5	28,4	42,0	17	25
291038	10	3/8	6,5	7,5	29,9	52,0	20	10
291238	12	3/8	6,5	7,5	31,4	52,0	20	10
291212	12	1/2	10,0	9	34,9	61,0	26	10
291412	14	1/2	10,0	9	35,5	61,0	26	10

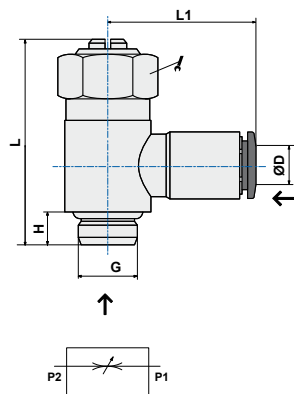



ART. 30 Regolatore di flusso bidirezionale
Bidirectional flow regulator

CODICE	ØD	G	H	L1	L		
300418	4	1/8	5,5	21,1	34	14	25
300618	6	1/8	5,5	24,3	34	14	25
300614	6	1/4	6,5	25,5	42	17	25
300818	8	1/8	5,5	24,8	34	14	25
300814	8	1/4	6,5	26,5	42	17	25
*300838	8	3/8	7,5	28,0	52	20	10
301014	10	1/4	6,5	28,4	42	17	25
*301038	10	3/8	7,5	29,9	52	20	10
*301238	12	3/8	7,5	31,4	52	20	10
*301212	12	1/2	9	34,9	61	26	10
301412	14	1/2	9	35,5	61	26	10



* con rondelle in pastica
* with plastic washer

ART. 28P Regolatore di flusso per valvola girevole
Swivel flow regulator for valve

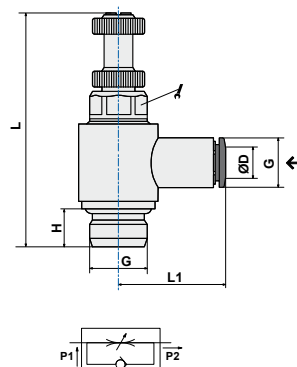
CODICE	ØD	G	H	L	L1		
2804M5P	4	5	4	19,5	33,7	8	25
280418P	4	1/8	5,5	43,0	21,1	9	25
280618P	6	1/8	5,5	43,0	24,3	9	25
280818P	8	1/8	5,5	43,0	24,8	9	25
280614P	6	1/4	6,5	50,0	25,5	12	25
280814P	8	1/4	6,5	50,0	26,5	12	25
281014P	10	1/4	6,5	50,0	28,4	12	25



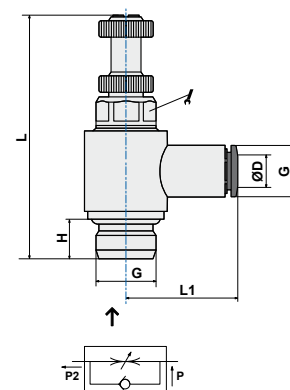

ART. 29P Regolatore di flusso per cilindro girevole
Swivel flow regulator for cylinder

CODICE	ØD	G	H	L	L1		
2904M5P	4	M5	4	19,5	33,7	8	25
290418P	4	1/8	5,5	43,0	21,1	9	25
2906M5P	4	M5	4	22,0	33,7	8	25
290618P	6	1/8	5,5	43,0	24,3	9	25
290818P	8	1/8	5,5	43,0	24,8	9	25
290614P	6	1/4	6,5	50,0	25,5	12	25
290814P	8	1/4	6,5	50,0	26,5	12	25
291014P	10	1/4	6,5	50,0	28,4	12	25



ART. 30P Regolatore di flusso bidirezionale
Bidirectional flow regulator

CODICE	ØD	G	H	L	L1		
300418P	4	1/8	5,5	43	21,1	9	25
300618P	6	1/8	5,5	43	24,3	9	25
300818P	8	1/8	5,5	43	24,8	9	25
300614P	6	1/4	6,5	50	25,5	12	25
300814P	8	1/4	6,5	50	26,5	12	25
301014P	10	1/4	6,5	50	28,4	12	25

