

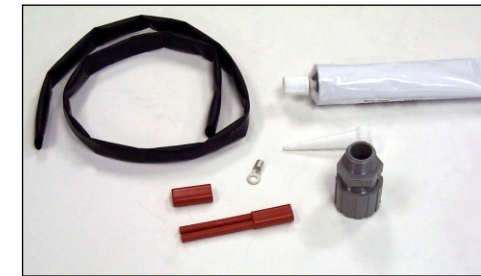

T9G90-UC Power & End Terminations for T, TY & TN Tracers

Installation Instructions

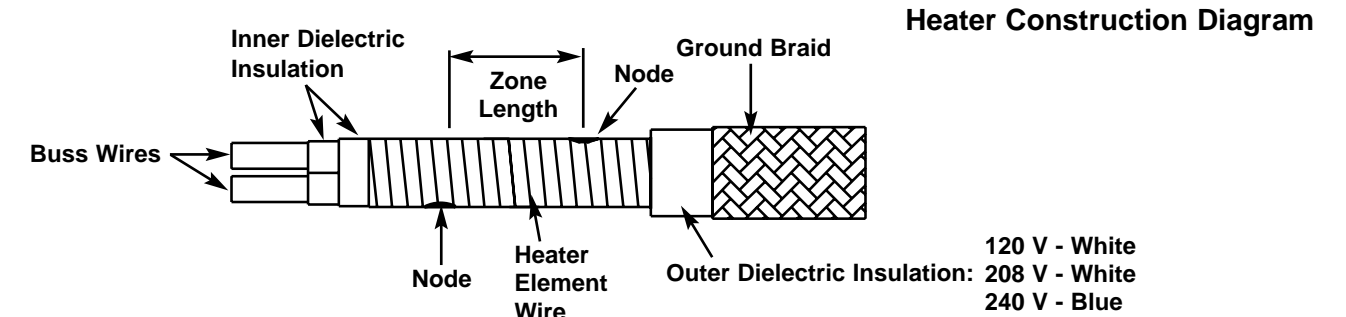

- T9G90-UC Kit Contents**
- 1 Silicone Two-Leg Connection Sleeve
 - 1 Silicone Tracer End Cap
 - 1 Tube of RTV Silicone
 - 1 Ring Terminal
 - 1 Entry Seal
 - 36" (915mm) Heat Shrink Tubing

CAUTION: All electrical connections and installations must comply with the requirements of all applicable national and local codes. If there is a conflict between these instructions and the requirements of applicable codes the requirements of the codes must be followed.

Locate Node

- Determine the zone length of the heater cable.
T18: 120 V - 24" (610mm) zone lengths
TY18: 208 V - 24" (610mm) zone lengths
TN18: 240 V - 30" (762mm) zone lengths
- Locate the node nearest to the end of the cable.

Peel back outer dielectric insulation to locate the heater element wire, then unravel 4-5 spirals from around the insulated core.

Using a standard electrical multi-meter set to measure resistance, connect one test lead to the end of the heater element wire, then contact each of the buss wires separately using the other test lead. One of the two buss wires will display a significantly higher electrical resistance value.

Make a note of the lower of the two electrical resistance readings. Refer to the chart on left, referencing the particular cable you are testing.

Using a tape measure mark the first node in relation to the end of the heating cable.

Resistance vs. Distance from Node

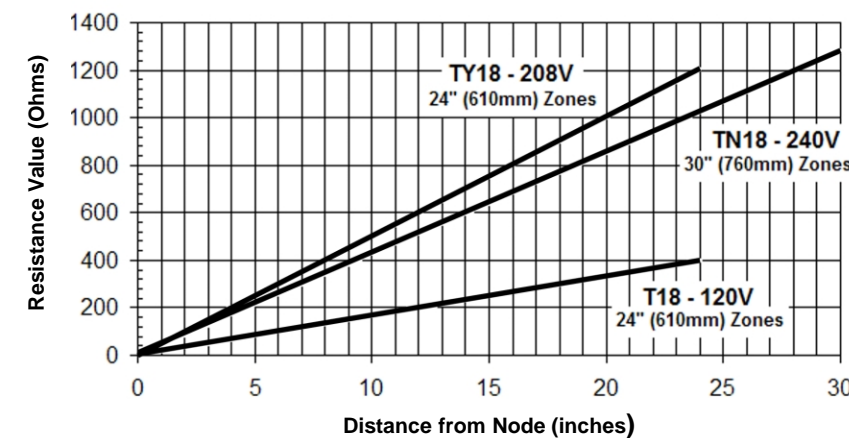

Example: Testing a TN18 cable you obtain a low resistance reading of 800 ohms. Find 800 ohms on the Y axis (Ohms) and read across until this line intersects the curve labeled TN18. Follow this point down to the X axis (Distance). The first node is 18.5" (470mm) from the end of the cable.

©2003 O'Brien Corporation • Bulletin QLT-T9G90-UC • 1 SEPT 03



O'Brien Corporation Worldwide Offices:

1900 Crystal Industrial Court • St. Louis, MO 63114 • Ph 314/236-2020 • Fax 314/236-2080
 Mallekotstraat 65 • B 2500 Lier Belgium • Ph (+32) 3 491 9865 • Fax (+32) 3 491 9876
 No. 42 Building No. 556 Faa Sai Rd. • Wai Gao Qiao Free Trade-Zone • Shanghai, China • Ph 86 21 50482125 • Fax 86 21 50482153
 O'Brien Canada • Suite 400 • 609 14th Street NW • Calgary, AB T2N 2A1 • Ph 403/730-7277 • Fax 403/730-7279

e-mail: sales@obcorp.com • www.obcorp.com

Power Connection

1. Locate the node nearest to the end of the cable (Refer to Locate Node section on Page 1).
2. Cut the heater cable to the desired cold lead length. To calculate the cold lead length: leave a minimum of 6" (150mm) from the first node to the entry seal, add length required to make connections inside junction box, and minimum lengths required by applicable national and local electrical codes.
3. Heat shrink tubing is furnished to provide additional corrosion protection to exposed ground braid. Cut the heat shrink tubing 7" (175 mm) shorter than the total length of exposed heater cable including hot and cold lead sections. Slide the heat shrink tubing over the heater cable all the way back to the end of the bundle. Starting at the bundle use a suitable heat gun to shrink the tubing.
4. Use a screwdriver to open braid about 6" (150mm) from the cut end of the heater cable or at the end of the heat shrink. Bend the heater cable back and pull it through the braid.
5. Twist the braid tight enough to insert the end into the ring terminal provided. Use a crimping tool to secure the ring terminal to the braid.
6. Remove outer dielectric insulation and heater element wire to expose 4" (100mm) of insulated buss wires. Unwrap the spiral heater element wire and cut it off flush with the end of the outer dielectric insulation.
7. Strip 1" of inner dielectric insulation from the end of each buss wire. The inner dielectric consists of two layers, one around the individual buss wires and a second layer covering both buss wires. Remove the inner layer of dielectric insulation covering both buss wires. This will leave the buss wires free but still covered with a layer of dielectric insulation.
8. Fill silicone two leg sleeve with RTV silicone and slide over end of heater cable.
9. Connect heater cable to power source using connectors suitable for 105°C and tighten gland.

⚠ CAUTION: END TERMINATION MUST BE INSTALLED BEFORE ENERGIZING CIRCUIT.

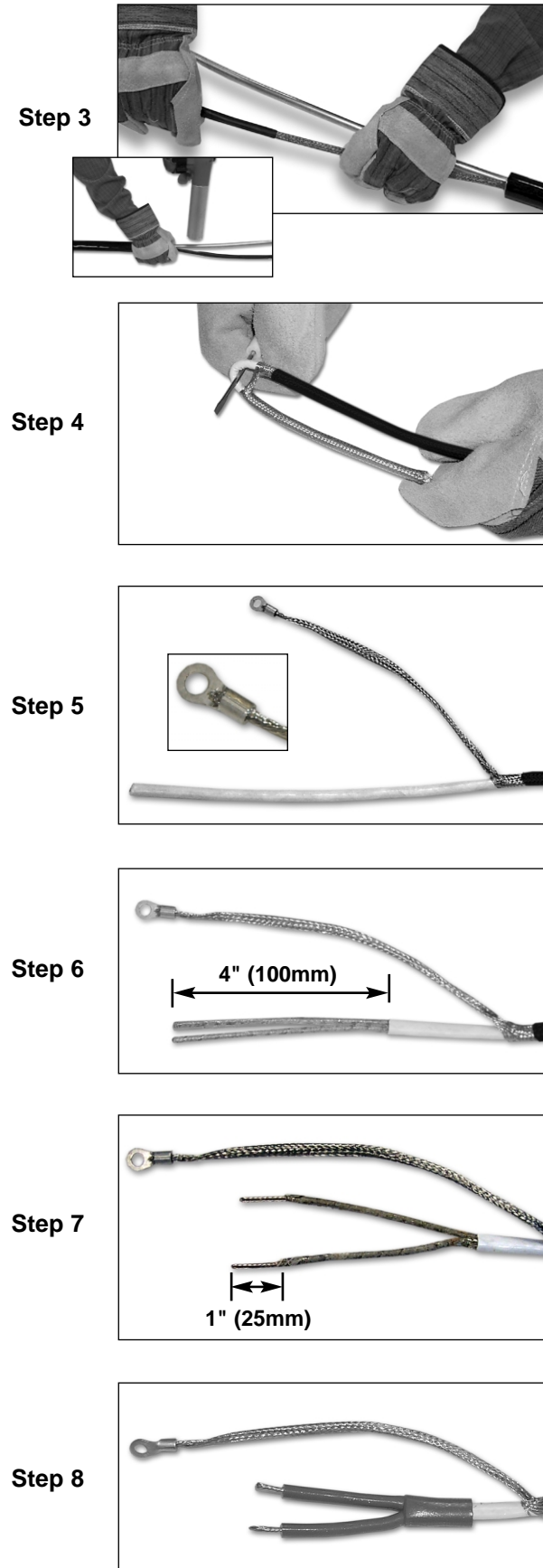

End Termination

1. Locate the node nearest to the end of the heater cable (Refer to Locate Node section on Page 1).
 2. Cut cable at least 6" (150mm) past last node.
 3. Heat shrink tubing is furnished to provide additional corrosion protection to exposed ground braid. Cut the heat shrink tubing 1" (25 mm) shorter than the total length of exposed heater cable including hot and cold lead sections. Slide the heat shrink tubing over the heater cable all the way back to the end of the bundle. Starting at the bundle use a suitable heat gun to shrink the tubing.
- Cut braid back 1" (25mm) from end of cable.
4. Remove outer dielectric insulation and heater resistance wire to expose 1" (25mm) of insulated buss wires.
 5. Cut one insulated buss wire 1/4" (6mm) shorter than other insulated wire so they can not come into contact with each other.
 6. Fill silicone end cap with RTV silicone and slide over end of cable.

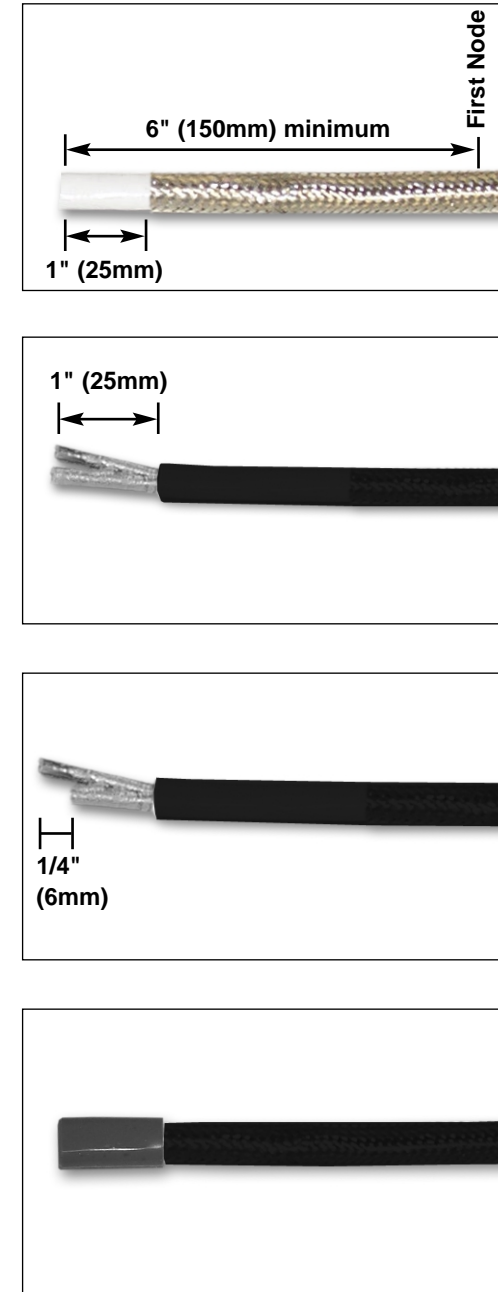

Heater Cable Wiring Diagram

