

Housing material: 16Mo3

Nominal diameter: DN15, DN20, DN25

Connections:

- Flanges DN 15-25, acc. DIN EN 1092-1, PN100
- Flanges 1/2"-1", acc. ANSI B 16.5, Class 600
- Female thread G 1/2"-1" (BSP) acc. DIN ISO 228-1
- Female thread 1/2"-1" NPT acc. to ANSI B 1.20.1
- Butt weld DN 15-25 acc. DIN EN 12627 and ANSI B 16.25
- Socket weld DN 15-25 acc. DN EN 12760 and ANSI B 16.11
- Other connections on request

Nominal pressure stage: PN 100

Housing operation-limits:

Max. operating pressure in bar g	100	100	87	74	70
Max. operating temperature in °C	100	200	300	400	450

Media: Steam, condensate

Function: A temperature drop opens while an increase of temperature closes the passage. As steam temperature the valve closes.

Installation: Horizontal or vertical

Function-limit of inlet unit: max. pressure difference = 80 bar

CE - Mark

The pressure equipment is in accordance with the Pressure Vessel Directive 97/23/EC, Article 3, subsection 3 and bears no CE mark.

Please state the following when making inquiries/placing orders:

High or low cooling range of condensate, actual operating pressure, quantity of condensate (kg/h).

Performance

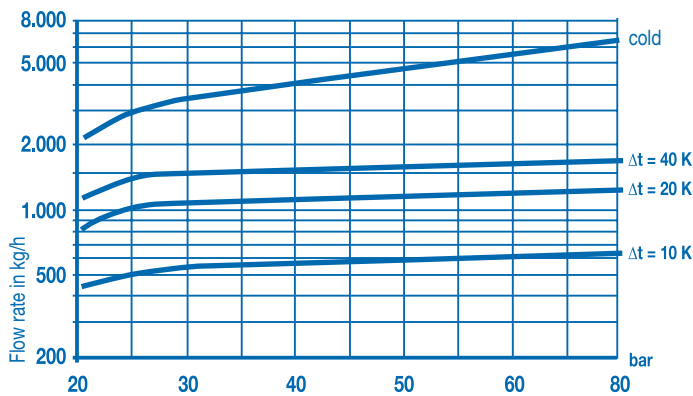

Pressure difference in bar (with reference to atmospheric pressure)

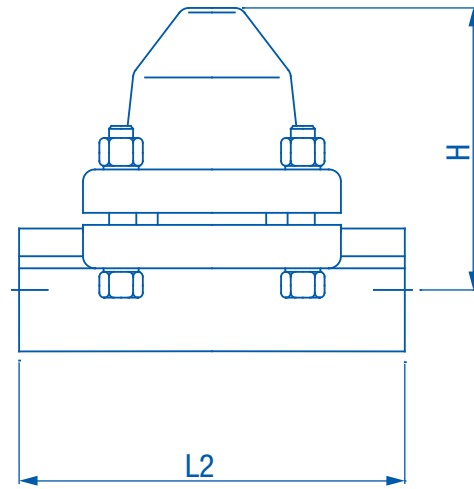
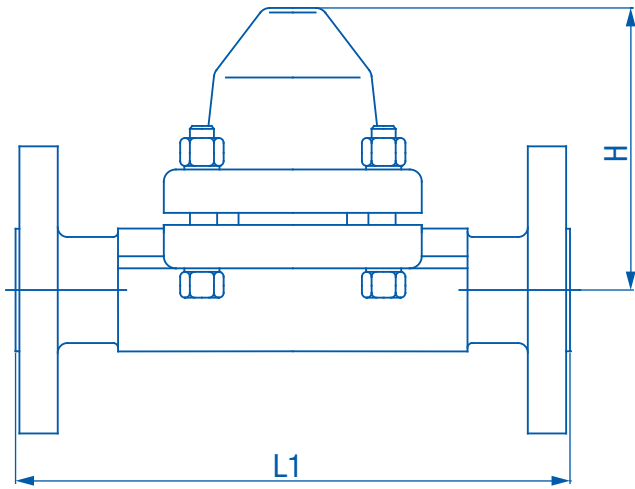

Dimensions (in mm), weight (in kg)

DN	15 (1/2")	20 (3/4")	25 (1")
L1	230	230	230
L2	160	160	160
H	120	120	120
Weight with flanges	8,3	9,1	9,5
Weight without flanges	6,8	6,8	6,8

Part List

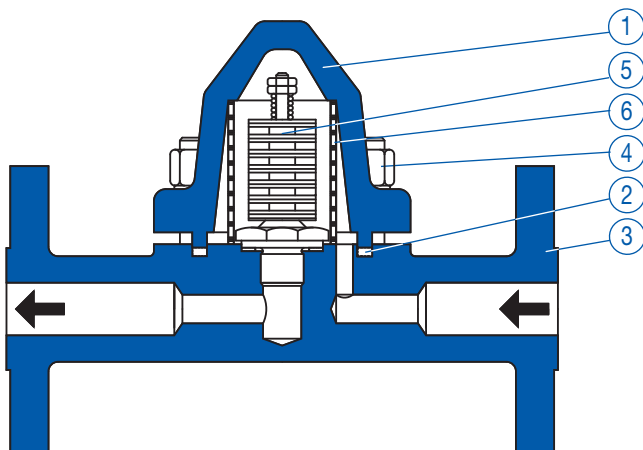

- 1 **Upper housing:** 16Mo3 comparable with A182 F1
- 2 **Housing gasket:** Graphite
- 3 **Lower housing:** 16Mo3 comparable with A182 F1
- 4 **Set crews with nuts:** 42CrMo4 / 24CrMo5 comparable with ASTM A193Gr.B7 / ASTM A194
- 5 **Bi-metal control assembly:** Stainless steel, Bi-metall
- 6 **Strainer:** 1.4301 comparable with AISI 304

To ensure correct parts delivery, specify part number, works standard sheet number 2440 and DN.