

REGOLATORI DI FLUSSO

- 1 **RAP**
Anello girevole - Swivel banjo "13" "13 R/*"
- 2 **TECNO-RAP**
Anello girevole - Swivel banjo "T13" "T13 R/*"
- 3 **Asta di regolazione con pomolo**
Adjusting stem with knob
28A (per valvola - for valve)
29A (per cilindro - for cylinder)
30A (bidirezionale - bidirectional)
- 4 **Asta di regolazione con taglio a cacciavite**
Adjusting stem with screwdriver cut
28A (per valvola - for valve)
29A (per cilindro - for cylinder)
30A (bidirezionale - bidirectional)

(*) Per asta M5
For M5 stem



CODIFICA DEI REGOLATORI DI FLUSSO

CODING OF FLOW REGULATORS

A	B	C	D	E
	28	04	18	
T	29	06	18	P

ESEMPI DI ORDINAZIONE

A	B	C	D	E
	28	04	18	
T	29	06	18	P

ORDERING EXAMPLES

A =		VERSIONE CON CORPO IN OTTONE
	T	VERSIONE CON CORPO IN TECNOPOLIMERO

A =		BRASS BODY VERSION
	T	TECHNOPOLYMER VERSION

B =	28	PER VALVOLA
	29	PER CILINDRO
	30	BIDIREZIONALE

B =	28	FOR VALVE
	29	FOR CYLINDER
	30	BIDIRECTIONAL

C =	04	PER TUBO DIAM. 4 MM
	06	PER TUBO DIAM. 6 MM
	08	PER TUBO DIAM. 8 MM
	10	PER TUBO DIAM. 10 MM
	12	PER TUBO DIAM. 12 MM

C =	04	FOR TUBE DIAM. 4 MM
	06	FOR TUBE DIAM. 6 MM
	08	FOR TUBE DIAM. 8 MM
	10	FOR TUBE DIAM. 10 MM
	12	FOR TUBE DIAM. 12 MM

D =	M5	FILETTATURA M5
	18	FILETTATURA 1/8
	14	FILETTATURA 1/4
	38	FILETTATURA 3/8
	12	FILETTATURA 1/2

D =	M5	THREAD M5
	18	THREAD 1/8
	14	THREAD 1/4
	38	THREAD 3/8
	12	THREAD 1/2

E =		ORIENTABILE CON TAGLIO A CACCIAVITE
	P	GIREVOLE CON POMELLO DI REGOLAZIONE

E =		ORIENTABLE TYPE WITH SCREWDRIVER CUT
	P	SWIVEL TYPE WITH ADJUSTING KNOB

ART. 28

Regolatore di flusso orientabile per valvola
Orientable flow regulator for valve

CODICE	ØD	G	ØA	H	L1	L		
2804M5	4	M5	1,9	4,0	19,5	24,0	8	25
280418	4	1/8	5,5	5,5	21,1	34,0	14	25
2806M5	6	M5	1,9	4,0	21,0	24,0	8	25
280618	6	1/8	5,5	5,5	24,3	34,0	14	25
280614	6	1/4	6,0	6,5	25,5	42,0	17	25
280818	8	1/8	5,5	5,5	24,8	34,0	14	25
280814	8	1/4	6,0	6,5	26,5	42,0	17	25
280838	8	3/8	8,0	7,5	28,0	52,0	20	10
281014	10	1/4	6,0	6,5	28,4	42,0	17	25
281038	10	3/8	8,0	7,5	29,9	52,0	20	10
281238	12	3/8	8,0	7,5	31,4	52,0	20	10

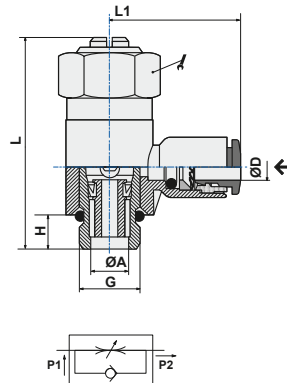

ART. 29

Regolatore di flusso orientabile per cilindro
Orientable flow regulator for valve

CODICE	ØD	G	ØA	H	L1	L		
2904M5	4	M5	1,9	4,0	19,5	24,0	8	25
290418	4	1/8	5,0	5,5	21,1	34,0	14	25
2906M5	6	M5	1,9	4,0	21,0	24,0	8	25
290618	6	1/8	5,0	5,5	24,3	34,0	14	25
290614	6	1/4	6,0	6,5	25,5	42,0	17	25
290818	8	1/8	5,0	5,5	24,8	34,0	14	25
290814	8	1/4	6,0	6,5	26,5	42,0	17	25
290838	8	3/8	6,5	7,5	28,0	52,0	20	10
291014	10	1/4	6,0	6,5	28,4	42,0	17	25
291038	10	3/8	6,5	7,5	29,9	52,0	20	10
291238	12	3/8	6,5	7,5	31,4	52,0	20	10
291212	12	1/2	10,0	9	34,9	61,0	26	10

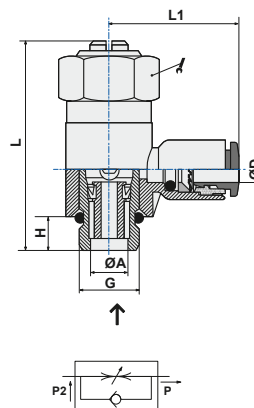

ART. 30

Regolatore di flusso orientabile bidirezionale
Orientable bidirectional flow regulator

CODICE	ØD	G	H	L1	L		
3004M5	4	M5	4,0	19,5	24	8	25
300418	4	1/8	5,5	21,1	34	14	25
3006M5	6	M5	4,0	21,0	24	8	25
300618	6	1/8	5,5	24,3	34	14	25
300614	6	1/4	6,5	25,5	42	17	25
300818	8	1/8	5,5	24,8	34	14	25
300814	8	1/4	6,5	26,5	42	17	25
300838	8	3/8	7,5	28,0	52	20	10
301014	10	1/4	6,5	28,4	42	17	25
301038	10	3/8	7,5	29,9	52	20	10
301238	12	3/8	7,5	31,4	52	20	10
301212	12	1/2	9	34,9	61	26	10

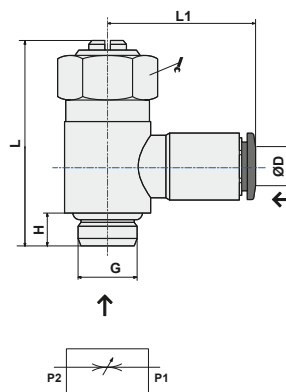

ART. 28P

 Regolatore di flusso girevole per valvola
Swivel flow regulator for valve

CODICE	ØD	G	H	L1	L		
2804M5P	4	M5	4	19,5	35,0	8	25
280418P	4	1/8	5,5	43,0	21,1	9	25
2806M5P	6	M5	4	21,0	35,0	8	25
280618P	6	1/8	5,5	43,0	24,3	9	25
280818P	8	1/8	5,5	43,0	24,8	9	25
280614P	6	1/4	6,5	50,0	25,5	12	25
280814P	8	1/4	6,5	50,0	26,5	12	25
281014P	10	1/4	6,5	50,0	28,4	12	25

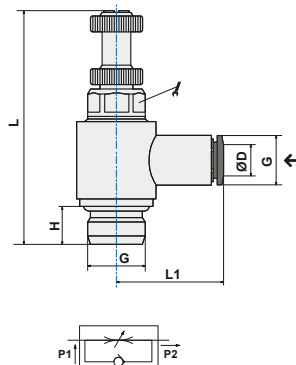
ART. 29P

 Regolatore di flusso girevole per cilindro
Swivel flow regulator for cylinder

CODICE	ØD	G	H	L1	L		
2904M5P	4	M5	4	19,5	35,0	8	25
290418P	4	1/8	5,5	43,0	21,1	9	25
2906M5P	6	M5	4	21,0	35,0	8	25
290618P	6	1/8	5,5	43,0	24,3	9	25
290818P	8	1/8	5,5	43,0	24,8	9	25
290614P	6	1/4	6,5	50,0	25,5	12	25
290814P	8	1/4	6,5	50,0	26,5	12	25
291014P	10	1/4	6,5	50,0	28,4	12	25

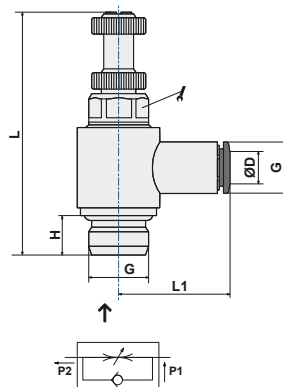
ART. 30P

 Regolatore di flusso girevole bidirezionale
Swivel bidirectional flow regulator

CODICE	ØD	G	H	L1	L		
3004M5P	4	M5	4	19,5	35,0	8	25
300418P	4	1/8	5,5	43	21,1	9	25
3006M5P	6	M5	4	21	35,0	8	25
300618P	6	1/8	5,5	43	24,3	9	25
300818P	8	1/8	5,5	43	24,8	9	25
300614P	6	1/4	6,5	50	25,5	12	25
300814P	8	1/4	6,5	50	26,5	12	25
301014P	10	1/4	6,5	50	28,4	12	25

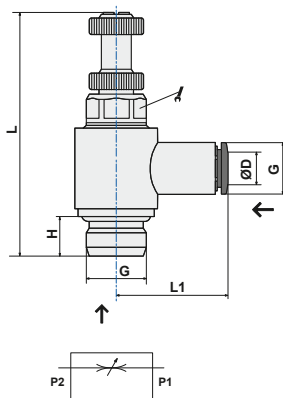

ART. B28

Regolatore di flusso unidirezionale per valvola
Unidirectional flow regulator for valve

CODICE	ØD	G	ØA	H	L1	L		
B2804M5	4	M5	1,9	4,0	19,5	24,0	8	25
B280418	4	1/8	5,5	5,5	21,1	34,0	14	25
B2806M5	6	M5	1,9	4,0	21,0	24,0	8	25
B280618	6	1/8	5,5	5,5	24,3	34,0	14	25
B280614	6	1/4	6,0	6,5	25,5	42,0	17	25
B280818	8	1/8	5,5	5,5	24,8	34,0	14	25
B280814	8	1/4	6,0	6,5	26,5	42,0	17	25
B280838	8	3/8	8,0	7,5	28,0	52,0	20	10
B281014	10	1/4	6,0	6,5	28,4	42,0	17	25
B281038	10	3/8	8,0	7,5	29,9	52,0	20	10
B281238	12	3/8	8,0	7,5	31,4	52,0	20	10

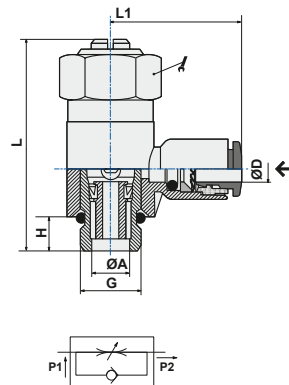

ART. B29

Regolatore di flusso unidirezionale per cilindro
Unidirectional flow regulator for cylinder

CODICE	ØD	G	ØA	H	L1	L		
B2904M5	4	M5	1,9	4,0	19,5	24,0	8	25
B290418	4	1/8	5,0	5,5	21,1	34,0	14	25
B2906M5	6	M5	1,9	4,0	21,0	24,0	8	25
B290618	6	1/8	5,0	5,5	24,3	34,0	14	25
B290614	6	1/4	6,0	6,5	25,5	42,0	17	25
B290818	8	1/8	5,0	5,5	24,8	34,0	14	25
B290814	8	1/4	6,0	6,5	26,5	42,0	17	25
B290838	8	3/8	6,5	7,5	28,0	52,0	20	10
B291014	10	1/4	6,0	6,5	28,4	42,0	17	25
B291038	10	3/8	6,5	7,5	29,9	52,0	20	10
B291238	12	3/8	6,5	7,5	31,4	52,0	20	10
B291212	12	1/2	10,0	9	34,9	61,0	26	10

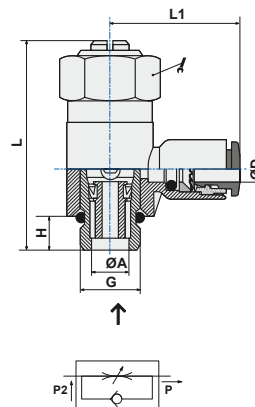

ART. B30

Regolatore di flusso bidirezionale
Bidirectional flow regulator

CODICE	ØD	G	H	L1	L		
B3004M5	4	M5	4,0	19,5	24	8	25
B300418	4	1/8	5,5	21,1	34	14	25
B3006M5	6	M5	4,0	21,0	24	8	25
B300618	6	1/8	5,5	24,3	34	14	25
B300614	6	1/4	6,5	25,5	42	17	25
B300818	8	1/8	5,5	24,8	34	14	25
B300814	8	1/4	6,5	26,5	42	17	25
B300838	8	3/8	7,5	28,0	52	20	10
B301014	10	1/4	6,5	28,4	42	17	25
B301038	10	3/8	7,5	29,9	52	20	10
B301238	12	3/8	7,5	31,4	52	20	10
B301212	12	1/2	9	34,9	61	26	10

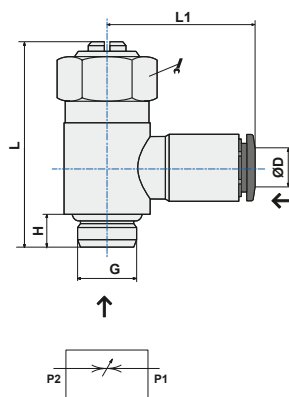

ART. B28P

 Regolatore di flusso per valvola girevole
Swivel flow regulator for valve

CODICE	ØD	G	H	L	L1		
B2804M5P	4	M5	4	19,5	35,0	8	25
B280418P	4	1/8	5,5	43,0	21,1	9	25
B2806M5P	6	M5	4	21,0	35,0	8	25
B280618P	6	1/8	5,5	43,0	24,3	9	25
B280818P	8	1/8	5,5	43,0	24,8	9	25
B280614P	6	1/4	6,5	50,0	25,5	12	25
B280814P	8	1/4	6,5	50,0	26,5	12	25
B281014P	10	1/4	6,5	50,0	28,0	12	25

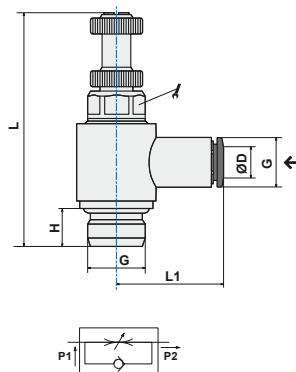
ART. B29P

 Regolatore di flusso per cilindro girevole
Swivel flow regulator for cylinder

CODICE	ØD	G	H	L	L1		
B204M5P	4	M5	4	19,5	35,0	8	25
B290418P	4	1/8	5,5	43,0	21,1	9	25
B2906M5P	6	M5	4	21,0	35,0	8	25
B290618P	6	1/8	5,5	43,0	24,3	9	25
B290818P	8	1/8	5,5	43,0	24,8	9	25
B290614P	6	1/4	6,5	50,0	25,5	12	25
B290814P	8	1/4	6,5	50,0	26,5	12	25
B291014P	10	1/4	6,5	50,0	28,4	12	25

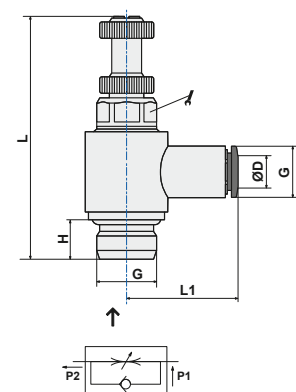
ART. B30P

 Regolatore di flusso bidirezionale
Bidirectional flow regulator

CODICE	ØD	G	H	L	L1		
B3004M5P	4	M5	4	19,5	35,0	8	25
B300418P	4	1/8	5,5	43	21,1	9	25
B3006M5P	6	M5	4	21	35,0	8	25
B300618P	6	1/8	5,5	43	24,3	9	25
B300818P	8	1/8	5,5	43	24,8	9	25
B300614P	6	1/4	6,5	50	25,5	12	25
B300814P	8	1/4	6,5	50	26,5	12	25
B301014P	10	1/4	6,5	50	28,4	12	25

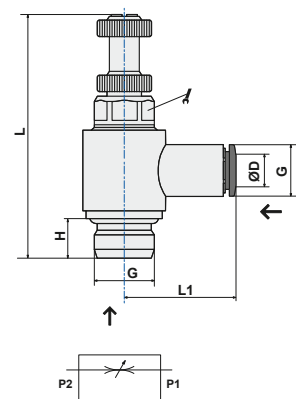

ART. 280T

Regolatore di flusso orientabile per valvola
Orientable flow regulator for valve

CODICE	ØD	G	ØA	H	L1	L		
280T04M5	4	M5	1,9	4,0	19,5	24,0	8	25
280T0418	4	1/8	5,5	5,5	21,1	34,0	14	25
280T06M5	6	M5	1,9	4,0	21,0	24,0	8	25
280T0618	6	1/8	5,5	5,5	24,3	34,0	14	25
280T0614	6	1/4	6,0	6,5	25,5	42,0	17	25
280T0818	8	1/8	5,5	5,5	24,8	34,0	14	25
280T0814	8	1/4	6,0	6,5	26,5	42,0	17	25
280T0838	8	3/8	8,0	7,5	28,0	52,0	20	10
280T1014	10	1/4	6,0	6,5	28,4	42,0	17	25
280T1038	10	3/8	8,0	7,5	29,9	52,0	20	10
280T1238	12	3/8	8,0	7,5	31,4	52,0	20	10

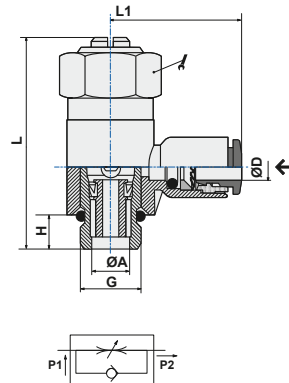

ART. 290T

Regolatore di flusso orientabile per cilindro
Orientable flow regulator for cylinder

CODICE	ØD	G	ØA	H	L1	L		
290T04M5	4	M5	1,9	4,0	19,5	24,0	8	25
290T0418	4	1/8	5,0	5,5	21,1	34,0	14	25
290T06M5	6	M5	1,9	4,0	21,0	24,0	8	25
290T0618	6	1/8	5,0	5,5	24,3	34,0	14	25
290T0614	6	1/4	6,0	6,5	25,5	42,0	17	25
290T0818	8	1/8	5,0	5,5	24,8	34,0	14	25
290T0814	8	1/4	6,0	6,5	26,5	42,0	17	25
290T0838	8	3/8	6,5	7,5	28,0	52,0	20	10
290T1014	10	1/4	6,0	6,5	28,4	42,0	17	25
290T1038	10	3/8	6,5	7,5	29,9	52,0	20	10
290T1238	12	3/8	6,5	7,5	31,4	52,0	20	10
290T1212	12	1/2	10,0	9	34,9	61,0	26	10

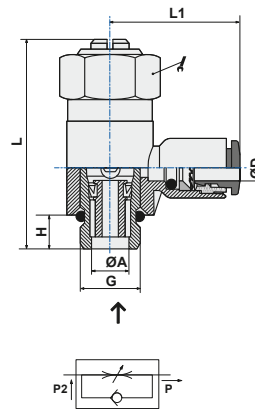

ART. 300T

Regolatore di flusso orientabile bidirezionale
Orientable bidirectional flow regulator

CODICE	ØD	G	H	L1	L		
300T04M5	4	M5	4,0	19,5	24	8	25
300T0418	4	1/8	5,5	21,1	34	14	25
300T06M5	6	M5	4,0	21,0	24	8	25
300T0618	6	1/8	5,5	24,3	34	14	25
300T0614	6	1/4	6,5	25,5	42	17	25
300T0818	8	1/8	5,5	24,8	34	14	25
300T0814	8	1/4	6,5	26,5	42	17	25
300T0838	8	3/8	7,5	28,0	52	20	10
300T1014	10	1/4	6,5	28,4	42	17	25
300T1038	10	3/8	7,5	29,9	52	20	10
300T1238	12	3/8	7,5	31,4	52	20	10
300T1212	12	1/2	9	34,9	61	26	10

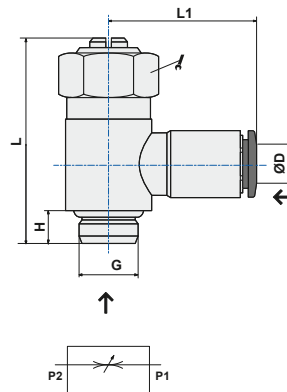

ART. 280P

 Regolatore di flusso girevole per valvola
Swivel flow regulator for valve

CODICE	ØD	G	H	L	L1		
28OT04M5P	4	M5	4	19,5	35,0	8	25
28OT0418P	4	1/8	5,5	43,0	21,1	9	25
28OT06M5P	6	M5	4	21,0	35,0	8	25
28OT0618P	6	1/8	5,5	43,0	24,3	9	25
28OT0818P	8	1/8	5,5	43,0	24,8	9	25
28OT0614P	6	1/4	6,5	50,0	25,5	12	25
28OT0814P	8	1/4	6,5	50,0	26,5	12	25
28OT1014P	10	1/4	6,5	50,0	28,4	12	25

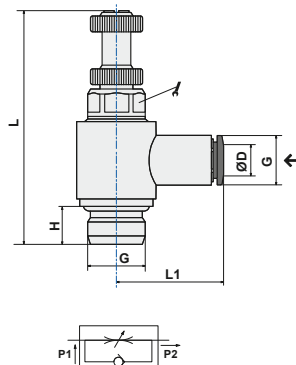
ART. 290P

 Regolatore di flusso girevole per cilindro
Swivel flow regulator for cylinder

CODICE	ØD	G	H	L	L1		
29OT04M5P	4	M5	4	19,5	35,0	8	25
29OT0418P	4	1/8	5,5	43,0	21,1	9	25
29OT06M5P	6	M5	4	21,0	35,0	8	25
29OT0618P	6	1/8	5,5	43,0	24,3	9	25
29OT0818P	8	1/8	5,5	43,0	24,8	9	25
29OT0614P	6	1/4	6,5	50,0	25,5	12	25
29OT0814P	8	1/4	6,5	50,0	26,5	12	25
29OT1014P	10	1/4	6,5	50,0	28,4	12	25

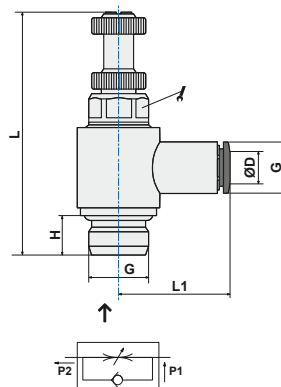
ART. 300P

 Regolatore di flusso girevole bidirezionale
Swivel bidirectional flow regulator

CODICE	ØD	G	H	L	L1		
30OT04M5P	4	M5	4	19,5	35,0	8	25
30OT0418P	4	1/8	5,5	43	21,1	9	25
30OT06M5P	6	M5	4	21	35,0	8	25
30OT0618P	6	1/8	5,5	43	24,3	9	25
30OT0818P	8	1/8	5,5	43	24,8	9	25
30OT0614P	6	1/4	6,5	50	25,5	12	25
30OT0814P	8	1/4	6,5	50	26,5	12	25
30OT1014P	10	1/4	6,5	50	28,4	12	25

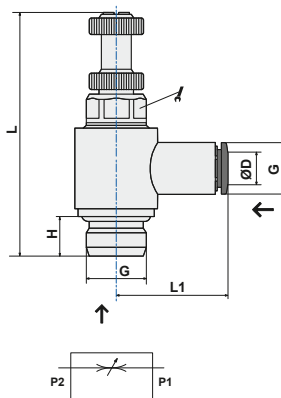

ART. T28

Regolatore di flusso orientabile per valvola
Orientable flow regulator for valve

CODICE	ØD	G	ØA	H	L1	L		
T2804M5	4	M5	2,0	4	19,0	22,5	8	25
T280418	4	1/8	5,0	5,5	21,1	34,0	14	25
T2806M5	6	M5	2,0	4	22,0	22,5	8	25
T280618	6	1/8	5,0	5,5	24,3	34,0	14	25
T280614	6	1/4	6,0	6,5	25,5	42,0	17	25
T280818	8	1/8	5,0	5,5	24,8	34,0	14	25
T280814	8	1/4	6,0	6,5	26,5	42,0	17	25
T280838	8	3/8	6,5	7,5	28,0	52,0	20	10
T281014	10	1/4	6,0	6,5	28,4	42,0	17	25
T281038	10	3/8	6,5	7,5	29,9	52,0	20	10
T281238	12	3/8	6,5	7,5	31,4	52,0	20	10

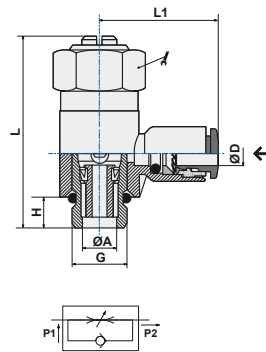

ART. T29

Regolatore di flusso orientabile per cilindro
Orientable flow regulator for cylinder

CODICE	ØD	G	ØA	H	L1	L		
T2904M5	4	M5	2,0	4	19,0	22,5	8	25
T290418	4	1/8	5,0	4	21,1	34,0	14	25
T2906M5	6	M5	2,0	4	22,0	22,5	8	25
T290618	6	1/8	5,0	5,5	24,3	34,0	14	25
T290614	6	1/4	6,0	6,5	25,5	42,0	17	25
T290818	8	1/8	5,0	5,5	24,8	34,0	14	25
T290814	8	1/4	6,0	6,5	26,5	42,0	17	25
T290838	8	3/8	6,5	7,5	28,0	52,0	20	10
T291014	10	1/4	6,0	6,5	28,4	42,0	17	25
T291038	10	3/8	6,5	7,5	29,9	52,0	20	10
T291012	10	1/2	10,0	9	30,0	61,0	26	10
T291238	12	3/8	6,5	7,5	31,4	52,0	20	10
T291212	12	1/2	10,0	9	34,9	61,0	26	10

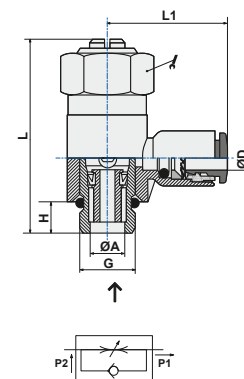

ART. T30

Regolatore di flusso orientabile bidirezionale
Orientable bidirectional flow regulator

CODICE	ØD	G	ØA	H	L1	L		
T3004M5	4	M5	2,0	4	19,0	22,5	8	25
T300418	4	1/8	5,0	4	21,1	34,0	14	25
T3006M5	6	M5	2,0	4	22,0	22,5	8	5
T300618	6	1/8	5,0	5,5	24,3	34,0	14	25
T300614	6	1/4	6,0	6,5	25,5	42,0	17	25
T300818	8	1/8	5,0	5,5	24,8	34,0	14	25
T300814	8	1/4	6,0	6,5	26,5	42,0	17	25
T300838	8	3/8	6,5	7,5	28,0	52,0	20	10
T301014	10	1/4	6,0	6,5	28,4	42,0	17	25
T301038	10	3/8	6,5	7,5	29,9	52,0	20	10
T301238	12	3/8	6,5	7,5	31,4	52,0	20	10
T301212	12	1/2	10,0	9	34,9	61,0	26	10

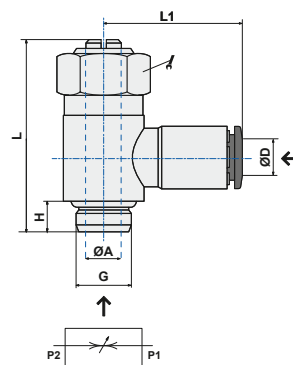

ART. T28P

 Regolatore di flusso girevole per valvola
Swivel flow regulator for valve

CODICE	ØD	G	B	L	L1			
T2804M5P	4	M5	4	34	19,0		8,0	25
T280418P	4	1/8	5,5	43	21,1		9,0	25
T2806M5P	6	M5	4	34	22,0		8,0	25
T280618P	6	1/8	5,5	43	24,3		9,0	25
T280614P	6	1/4	6,5	50	25,5		12,0	25
T280638P*	6	3/8	9,5	53	29,5		13,0	10
T280612P	6	1/2	12,0	61	30,2		13,0	10
T280818P	8	1/8	5,5	43	24,8		9,0	25
T280814P	8	1/4	6,5	50	26,5		12,0	25
T280838P*	8	3/8	9,5	53	30,0		14,4	10
T280812P*	8	1/2	1,2	61	35,8		14,4	10
T281018P*	10	1/8	6,5	42	30,7		18,4	10
T281014P	10	1/4	6,5	50	28,4		12,0	25
T281038P*	10	3/8	9,5	53	33,5		18,4	10
T281012P*	10	1/2	12,0	61	36,5		18,4	10
T281214P*	12	1/4	8,5	48	33,7		21,0	10
T281238P*	12	3/8	9,5	53	35,5		19,0	10
T281212P*	12	1/2	12,0	61	36,5		21,0	10

* = di importazione - imported

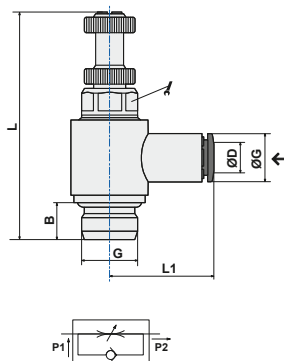
ART. T29P

 Regolatore di flusso girevole per cilindro
Swivel flow regulator for cylinder

CODICE	ØD	G	B	L	L1			
T2904M5P	4	M5	4	34	15,0		8,0	25
T290418P	4	1/8	5,5	43	21,1		9,0	25
T290414P*	4	1/4	6,5	50	25,5		12,0	25
T2906M5P	6	M5	4	34	22,0		8,0	25
T290618P	6	1/8	5,5	43	24,3		9,0	25
T290614P	6	1/4	6,5	50	25,5		12,0	25
T290638P*	6	3/8	9,5	53	29,5		13,0	10
T290612P*	6	1/2	12,0	61	30,2		13,0	10
T290818P	8	1/8	5,5	43	24,8		9,0	25
T290814P	8	1/4	6,5	50	26,5		12,0	25
T290838P*	8	3/8	9,5	53	30,0		14,4	10
T290812P*	8	1/2	1,2	61	35,8		14,4	10
T291018P*	10	1/8	6,5	42	30,7		18,4	10
T291014P	10	1/4	6,5	50	28,4		12,0	25
T291038P*	10	3/8	9,5	53	33,5		18,4	10
T291012P*	10	1/2	12,0	61	36,5		18,4	10
T291214P*	12	1/4	8,5	48	33,7		21,0	10
T291238P*	12	3/8	9,5	53	35,5		19,0	10
T291212P*	12	1/2	12,0	61	36,5		21,0	10

* = di importazione - imported

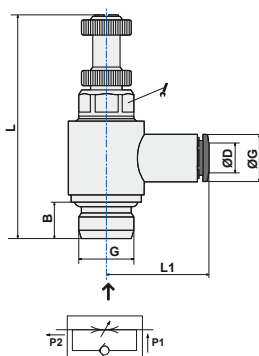

ART. T30P

Regolatore di flusso girevole bidirezionale
Swivel bidirectional flow regulator

CODICE	ØD	G	B	L	L1			
T3004M5P	4	M5	4	34	19,0		8	25
T300418P	4	1/8	5,5	43	21,1		9	25
T3006M5P	6	M5	4	34	22,0		8	25
T300618P	6	1/8	5,5	43	24,3		9	25
T300614P	6	1/4	6,5	50	25,5		12	25
T300818P	8	1/8	5,5	43	24,8		9	25
T300814P	8	1/4	6,5	50	26,5		12	25
T301014P	10	1/4	6,5	50	28,4		12	25

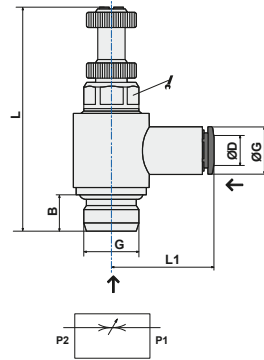

ART. T31

Regolatore di flusso in linea
Flat flow regulator

CODICE	ØD	B	G	F	S	Ød	J	
T310400	4	40,5	14,4	6,5	6,5	3,2	14	25
T310600	6	48,7	25,3	8,5	11,0	4,3	20	25
T310800	8	54,4	25,1	9,5	12,0	4,3	22	25
T311000	10	64,3	28,8	10,5	12,5	4,3	26	10
T311200	12	74,6	26,1	13,0	16,0	4,3	32	10

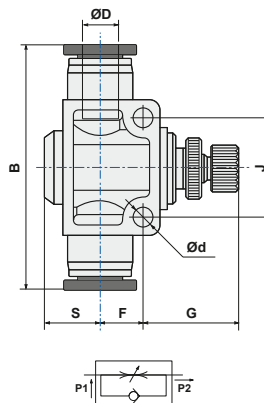

NOTA: articolo di importazione - NOTE: imported item

ART. TB28

 Regolatore di flusso orientabile per valvola
Orientable flow regulator for valve

CODICE	ØD	G	ØA	H	L1	L		
TB2804M5	4	M5	2,0	4	19,0	22,5	8	25
TB280418	4	1/8	5,0	5,5	21,1	34,0	14	25
TB2806M5	6	M5	2,0	4	22,0	22,5	8	25
TB280618	6	1/8	5,0	5,5	24,3	34,0	14	25
TB280614	6	1/4	6,0	6,5	25,5	42,0	17	25
TB280818	8	1/8	5,0	5,5	24,8	34,0	14	25
TB280814	8	1/4	6,0	6,5	26,5	42,0	17	25
TB280838	8	3/8	6,5	7,5	28,0	52,0	20	10
TB281014	10	1/4	6,0	6,5	28,4	42,0	17	25
TB281038	10	3/8	6,5	7,5	29,9	52,0	20	10
TB281238	12	3/8	6,5	7,5	31,4	52,0	20	10

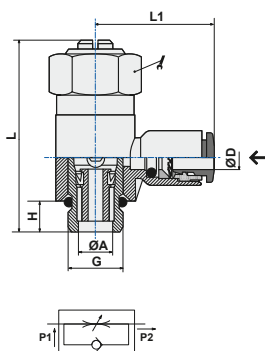
ART. TB29

 Regolatore di flusso orientabile per cilindro
Orientable flow regulator for cylinder

CODICE	ØD	G	ØA	H	L1	L		
TB2904M5	4	M5	2,0	4	19,0	22,5	8	25
TB290418	4	1/8	5,0	4	21,1	34,0	14	25
TB2906M5	6	M5	2,0	4	22,0	22,5	8	25
TB290618	6	1/8	5,0	5,5	24,3	34,0	14	25
TB290614	6	1/4	6,0	6,5	25,5	42,0	17	25
TB290818	8	1/8	5,0	5,5	24,8	34,0	14	25
TB290814	8	1/4	6,0	6,5	26,5	42,0	17	25
TB290838	8	3/8	6,5	7,5	28,0	52,0	20	10
TB291014	10	1/4	6,0	6,5	28,4	42,0	17	25
TB291038	10	3/8	6,5	7,5	29,9	52,0	20	10
TB291012	10	1/2	10,0	9	30,0	61,0	26	10
TB291238	12	3/8	6,5	7,5	31,4	52,0	20	10
TB291212	12	1/2	10,0	9	34,9	61,0	26	10

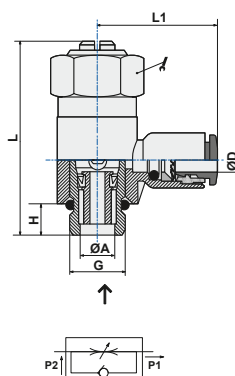
ART. TB30

 Regolatore di flusso orientabile bidirezionale
Orientable bidirectional flow regulator

CODICE	ØD	G	ØA	H	L1	L		
TB3004M5	4	M5	2,0	4	19,0	22,5	8	25
TB300418	4	1/8	5,0	4	21,1	34,0	14	25
TB3006M5	6	M5	2,0	4	22,0	22,5	8	5
TB300618	6	1/8	5,0	5,5	24,3	34,0	14	25
TB300614	6	1/4	6,0	6,5	25,5	42,0	17	25
TB300818	8	1/8	5,0	5,5	24,8	34,0	14	25
TB300814	8	1/4	6,0	6,5	26,5	42,0	17	25
TB300838	8	3/8	6,5	7,5	28,0	52,0	20	10
TB301014	10	1/4	6,0	6,5	28,4	42,0	17	25
TB301038	10	3/8	6,5	7,5	29,9	52,0	20	10
TB301238	12	3/8	6,5	7,5	31,4	52,0	20	10
TB301212	12	1/2	10,0	9	34,9	61,0	26	10

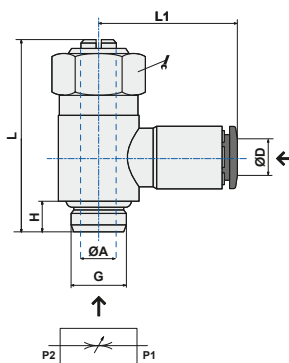

ART. TB28P

Regolatore di flusso girevole per valvola
Swivel flow regulator for valve

CODICE	ØD	G	B	L	L1			
TB2804M5P	4	M5	4	34	19,0		8,0	25
TB280418P	4	1/8	5,5	43	21,1		9,0	25
TB2806M5P	6	M5	4	34	22,0		8,0	25
TB280618P	6	1/8	5,5	43	24,3		9,0	25
TB280614P	6	1/4	6,5	50	25,5		12,0	25
TB280638P*	6	3/8	9,5	53	29,5		13,0	10
TB280612P	6	1/2	12,0	61	30,2		13,0	10
TB280818P	8	1/8	5,5	43	24,8		9,0	25
TB280814P	8	1/4	6,5	50	26,5		12,0	25
TB280838P*	8	3/8	9,5	53	30,0		14,4	10
TB280812P*	8	1/2	1,2	61	35,8		14,4	10
TB281018P*	10	1/8	6,5	42	30,7		18,4	10
TB281014P	10	1/4	6,5	50	28,4		12,0	25
TB281038P*	10	3/8	9,5	53	33,5		18,4	10
TB281012P*	10	1/2	12,0	61	36,5		18,4	10
TB281214P*	12	1/4	8,5	48	33,7		21,0	10
TB281238P*	12	3/8	9,5	53	35,5		19,0	10
TB281212P*	12	1/2	12,0	61	36,5		21,0	10

* = di importazione - imported

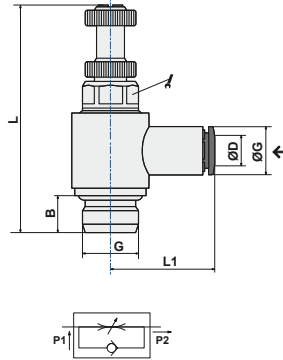

ART. TB29P

Regolatore di flusso girevole per cilindro
Swivel flow regulator for cylinder

CODICE	ØD	G	B	L	L1			
TB2904M5P	4	M5	4	34	15,0		8,0	25
TB290418P	4	1/8	5,5	43	21,1		9,0	25
TB290414P*	4	1/4	6,5	50	25,5		12,0	25
TB2906M5P	6	M5	4	34	22,0		8,0	25
TB290618P	6	1/8	5,5	43	24,3		9,0	25
TB290614P	6	1/4	6,5	50	25,5		12,0	25
TB290638P*	6	3/8	9,5	53	29,5		13,0	10
TB290612P*	6	1/2	12,0	61	30,2		13,0	10
TB290818P	8	1/8	5,5	43	24,8		9,0	25
TB290814P	8	1/4	6,5	50	26,5		12,0	25
TB290838P*	8	3/8	9,5	53	30,0		14,4	10
TB290812P*	8	1/2	1,2	61	35,8		14,4	10
TB291018P*	10	1/8	6,5	42	30,7		18,4	10
TB291014P	10	1/4	6,5	50	28,4		12,0	25
TB291038P*	10	3/8	9,5	53	33,5		18,4	10
TB291012P*	10	1/2	12,0	61	36,5		18,4	10
T2B91214P*	12	1/4	8,5	48	33,7		21,0	10
TB291238P*	12	3/8	9,5	53	35,5		19,0	10
TB291212P*	12	1/2	12,0	61	36,5		21,0	10

* = di importazione - imported

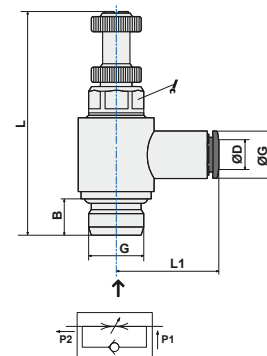

ART. TB30P

Regolatore di flusso girevole bidirezionale
Swivel bidirectional flow regulator

CODICE	ØD	G	B	L	L1			
TB3004M5P	4	M5	4	34	19,0		8	25
TB300418P	4	1/8	5,5	43	21,1		9	25
TB3006M5P	6	M5	4	34	22,0		8	25
TB300618P	6	1/8	5,5	43	24,3		9	25
TB300614P	6	1/4	6,5	50	25,5		12	25
TB300818P	8	1/8	5,5	43	24,8		9	25
TB300814P	8	1/4	6,5	50	26,5		12	25
TB301014P	10	1/4	6,5	50	28,4		12	25

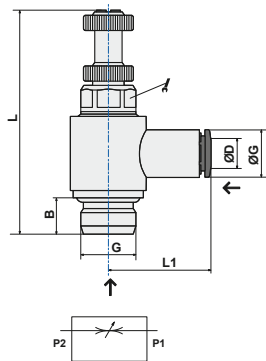

ART. TB31

Regolatore di flusso in linea
Flat flow regulator

CODICE	ØD	B	G	F	S	Ød	J	
TB310400	4	40,5	14,4	6,5	6,5	3,2	14	25
TB310600	6	48,7	25,3	8,5	11,0	4,3	20	25
TB310800	8	54,4	25,1	9,5	12,0	4,3	22	25
TB311000	10	64,3	28,8	10,5	12,5	4,3	26	10
TB311200	12	74,6	26,1	13,0	16,0	4,3	32	10

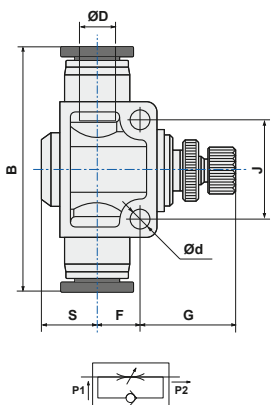

NOTA: articolo di importazione - NOTE: imported item

ART. 28/29/30A Asta regolatore orientabile
Positioned flow regulator stem

CODICE	L	ØB	H	G	ØA	🔧	📏
28/29/30AM5 (*)	24,0	6,0	4,0	M5	5,0	8,0	10
28/29/30A18	31,5	9,8	7,0	1/8	13,5	14,0	10
28/29/30A14	38,0	13,0	8,0	1/4	17,0	17,0	10
28/29/30A38	46,5	16,5	9,0	3/8	21,0	21,0	10
29A12 / 30A12	53,0	20,5	10	1/2	26	26	5

(*) Nota: 13R/T13R

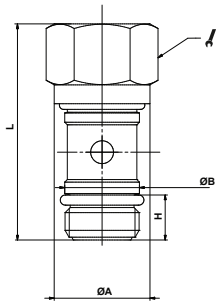

ART. 28/29/30AP Asta regolatore girevole
Swivel flow regulator stem

CODICE	L max	ØB	H	G	ØA	🔧	📏
28/29/30AM5P (*)	35,0	6,0	4,2	M5	5,0	8,0	10
28/29/30A18P	37,5	9,8	5,9	1/8	13,5	9,0	10
28/29/30A14P	44,0	13,0	7,0	1/4	17,0	12,0	10

(*) Nota: 13R/T13R

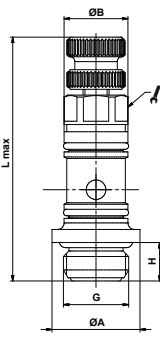

28 = per valvola (IN type) 29 = per cilindro (OUT type) 30 = bidirezionale (bi-directional)

ART. T29GS Regolatore di flusso per cilindro con ghiera di blocco
Speed controller for cylinders with lock cap

CODICE	ØD	G	L1	L2	L3	L4	ØD1	🔧
T29GS04M5	4	M5	3,5	18,0	28,0	18,0	9,5	9
T29GS0418	4	G1/8	5,5	21,5	33,5	24,0	13,0	13
T29GS06M5	6	M5	3,5	17,6	28,0	19,0	11,5	9
T29GS0618	6	G1/8	5,5	21,5	33,5	22,3	13,0	13
T29GS0614	6	G1/4	7,5	24,5	38,7	24,0	13,0	17
T29GS0818	8	G1/8	5,5	21,5	33,5	25,5	14,5	13
T29GS0814	8	G1/4	7,5	24,5	38,7	27,0	14,5	17

Di importazione
Imported

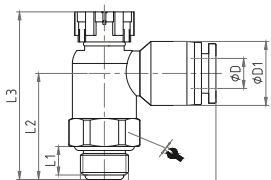

INFORMAZIONI TECNICHE AGGIUNTIVE

Prove di portata

Prova effettuata presso il laboratorio Pneumax su alcuni campioni di regolatori di flusso alle seguenti condizioni:

Fluido	aria filtrata
Temperatura	20°C
Pressione	6 bar

ADDITIONAL TECHNICAL INFORMATION

Flow tests

Test carried out at the Pneumax laboratory on a flow regulators sample under the following conditions:

Fluid	filtered air
Temperature	20°C
Pressure	6 bar

Risultati della prova • Tests results

N° giri spillo Needle turns	Portata • Flow (ltr/min)						
	T290618	T290618P	T290614	T290614P	T290838	T290838P	T291012P
0,0	0	0	0	0	0	0	0
0,5	5	5	38	2	40	21	30
1,0	10	10	48	23	92	40	63
1,5	20	16	55	41	139	59	94
2,0	23	22	65	50	185	78	123
2,5	27	25	72	58	230	96	156
3,0	30	28	80	64	272	115	186
3,5	34	33	88	73	318	135	220
4,0	37	43	100	81	361	153	251
4,5	40	55	121	97	405	171	282
5,0	44	68	145	118	447	190	312
5,5	52	80	170	142	489	207	343
6,0	64	93	196	169	530	224	375
6,5	75	105	220	193	580	240	404
7,0	88	118	241	217	664	251	437
7,5	101	127	260	238	811	276	466
8,0	113	172	277	255	963	392	480
8,5	126	240	294	273	1075	530	485
9,0	136	283	325	300	1154	635	543
9,5	158	300	355	334	1200	700	635
10,0	191		383	364	1228	750	845
10,5	195		408	379	1235	778	1083
11,0			421	400		802	1288
11,5			427	407		814	1454
12,0			432	414		824	1588
12,5			434	417		833	1685
13,0			436	418		835	1754
13,5							1795
14,0							1820
14,5							
15,0							

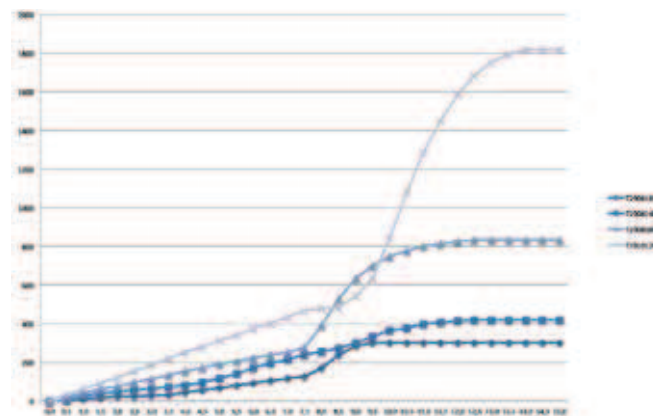
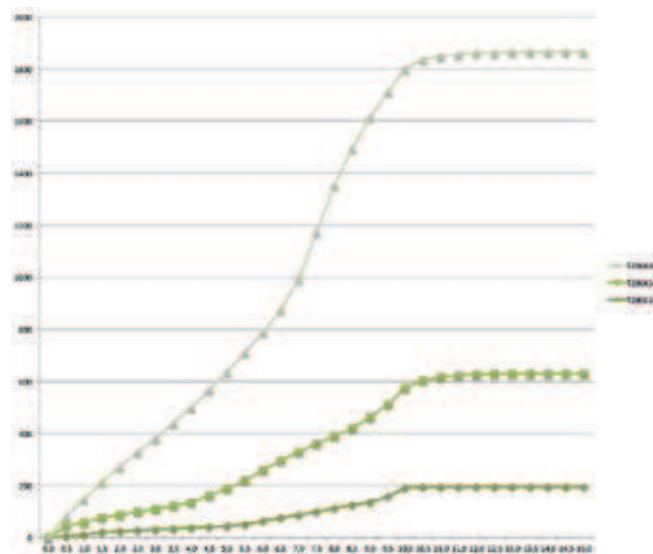

Risultati della prova • Tests results

N° giri spillo Needle turns	Portata • Flow (ltr/min)							
	T280618	T280618P	T280614	T280838P	T281212P	T290838-V	T290838-B	T290838-C
0,0	0	0	0	0	0	0	0	0
0,5	0	0	20	22	35	42	39	88
1,0	6	10	24	40	70	82	79	185
1,5	12	13	34	59	100	124	122	280
2,0	14	16	43	78	138	159	163	375
2,5	17	20	48	100	171	200	205	480
3,0	20	22	57	120	207	236	244	582
3,5	22	25	65	141	240	272	282	680
4,0	24	32	80	160	274	307	320	780
4,5	27	44	98	184	306	342	357	880
5,0	34	55	115	207	338	377	392	1110
5,5	44	69	142	226	370	411	425	1428
6,0	53	81	162	255	402	445	460	1628
6,5	64	94	182	360	433	478	496	1720
7,0	74	106	202	498	464	529	546	1767
7,5	84	120	221	614	494	640	642	1798
8,0	95	155	247	712	525	800	793	1820
8,5	125	207	294	778	560	970	983	1825
9,0	184	250	365	808	678	1088	1129	
9,5	185	269	442	823	877	1145	1222	
10,0		275	495	830	1079	1185		
10,5			528	835	1280	1187		
11,0			541	838	1340			
11,5			549	843	1623			
12,0			552		1760			
12,5			553		1880			
13,0					1970			
13,5					2055			
14,0					2060			
14,5								
15,0								

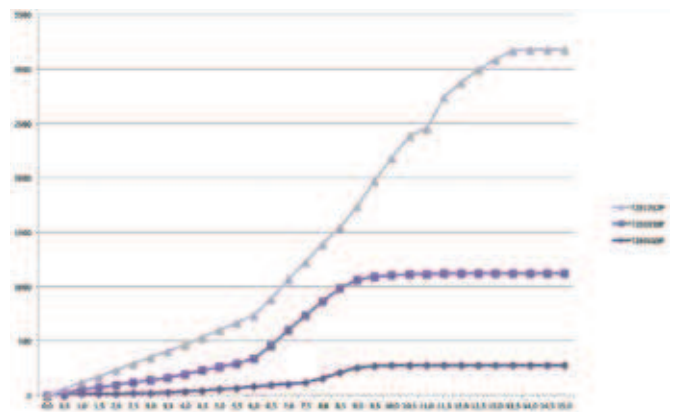
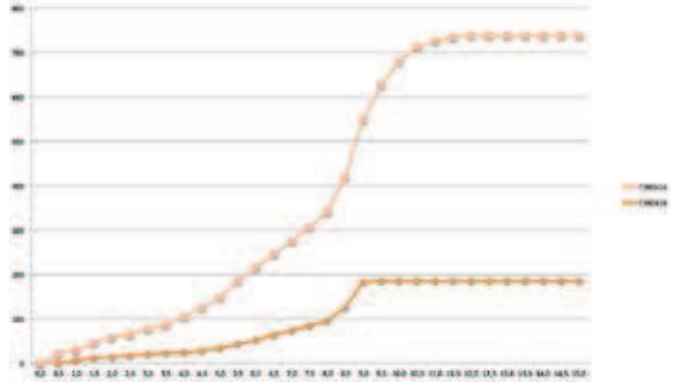

Codice regolatore Regulator code	Portata • Flow (ltr/min)	
	6 bar Δp=1 Nominale 6 bar Δp=1 Nominal	6 bar max Scarico libero 6 bar max Free exhaust
T280618	120	185
T280618P	170	280
T280614	320	550
T280838P	505	840
T281212P	1230	2060
T290618	120	195
T290618P	175	300
T290614	260	435
T290614P	245	420
T290838	790	1235
T290838P	525	835
T291012P	1120	1820
T300618	200	330
T301014	365	655
T290838-V	705	1185
T290838-B	775	1070
T291212-C	1160	1825

Aste G1/8" anello tubo 4 Stems G1/8" banjo diam. 4	1	2	3	4	5	m/a	um
Serraggio OK • Clamping OK	2,5	2,5	2,5	2,5		2,5	Nm
Anello schiacciato • Ring crushed	3,5	3,5	3,0	3,3		3,5	Nm
Anello deformato • Deformed ring	5,0	5,5	4,5	5,0		5,0	Nm
Rottura asta • Stem breakage	16,4	16,4	15,3	14,5		16,0	Nm
Aste G1/4" anello tubo 6 Stems G1/4" banjo diam. 6	1	2	3	4	5	m/a	um
Serraggio OK • Clamping OK	2,5	3,0	2,5	2,5	3,0	3,0	Nm
Anello schiacciato • Ring crushed	4,0	5,0	5,5	6,0	6,0	5,5	Nm
Anello deformato • Deformed ring	7,0	7,5	8,0	8,5	9,0	8,0	Nm
Rottura asta • Stem breakage	33,0	32,1	30,1	32,4	33,4	32,0	Nm
Aste G3/8" anello tubo 8 Stems G3/8" banjo diam. 8	1	2	3	4	5	m/a	um
Serraggio OK • Clamping OK	4,0	5,0				4,5	Nm
Anello schiacciato • Ring crushed	8,0	8,5				8,0	Nm
Anello deformato • Deformed ring	15,0	16,0				16,0	Nm
Rottura asta • Stem breakage	41,9	44,3				43,0	Nm

BREVE DESCRIZIONE

I Regolatori di flusso della nostra serie RAP e TRAP sono realizzati in Italia, a garanzia di elevati standard di qualità secondo le normative ISO di riferimento, e rispondono alle seguenti specifiche tecniche e applicative.

SHORT DESCRIPTION

The RAP and TRAP Speed controllers series are produced in Italy according to the reference ISO norms as warranty of high quality level and answer to the followings technical specifications and applications.

SCHEDA TECNICA TECHNICAL SHEET

FLUIDI UTILIZZABILI <i>EMPLOYABLE FLUIDS</i>		Aria compressa (per altri fluidi contattare il nostro Ufficio Tecnico) <i>Compressed air (for different fluid pls contact our Technical Dept.)</i>
APPLICAZIONI <i>APPLICATIONS</i>		Pneumatica, idraulica a bassa pressione, secondo normativa DIN 3861-3870. <i>Pneumatic circuits, low pressure hydraulic applications, according to DIN 3861-3870 norms.</i>
TUBI CONSIGLIATI <i>SUGGESTED TUBES</i>		TPU (Poliuretano), PA11/PA12 (Poliammide), TPE (Polietilene), TCO (Copoliestere) <i>TPU (Polyurethane), PA11/PA12 (Polyamide), TPE (Polyethylene), TCO (Copolyester)</i>
TOLLERANZE TUBI <i>TUBES TOLERANCES</i>		Diam. da 4 a 10 mm +/- 0,05 Diam. da 12 mm +/- 0,1 <i>Diam. between 4 and 10 mm +/- 0,05 Diam. from 12 mm +/- 0,1</i>
TEMPERATURE E PRESSIONI <i>TEMPERATURE AND PRESSURE</i>	VALORI LIMITE CONSIGLIATI <i>RECOMMENDED LIMIT VALUES</i>	Le temperature e le pressioni dipendono generalmente dalle caratteristiche del tubo impiegato, e comunque si suggerisce di non superare i 15 bar e temperature comprese fra -20°C e +70°C. <i>Temperatures and pressures usually depend by the technical features of the employed tubes, anyway it is suggested a limit working pressure of 15 bar and a temperature range between -20°C and +70°C</i>
	DATI TECNICI DI PROVA <i>TECHNICAL TESTING DATA</i>	A pagg. 34 e 64 sono riportati i dati di resistenza a trazione e i valori limite di utilizzo (Pressione e Temperature) relativi ai principali tubi commerciali. <i>At pages 34 and 64 are indicated the load traction resistance values and the main working and breaking limit (Pressure and Temperature) of the main commercial tubing.</i>
	NOTA <i>NOTE</i>	Per dati più puntuali consultare il catalogo tecnico del proprio fornitore di tubi. <i>For more complete informations pls read the technical catalogue of your tube supplier.</i>
FILETTATURE <i>THREAD TYPE</i>		BSP cilindrica UNI-ISO 228 <i>BSP paralell UNI-ISO 228</i>
MATERIALI <i>MATERIALS</i>	corpo RAP, colonnina di regolazione, Spintore "OT" <i>RAP body, regulation stem, "OT" sleeve</i>	Ottone UNI EN 12164 CW614N <i>Brass UNI EN 12164 CW614N</i>
	corpo TRAP, spintore, distanziale, sottomolla <i>TRAP body, sleeve, collar and back ring</i>	POM copolimero ISO1043-1 <i>POM copolymer ISO1043-1</i>
	pinza <i>spring</i>	Acciaio Inox AISI 301 austenitico <i>Stainless steel AISI 301 austenitic</i>
	guarnizioni tenuta <i>seals</i>	NBR 70 DWGV-EN549 UL157 <i>NBR 70 DWGV-EN549 UL157</i>