

54-2700 Series

Regulators - Relief / Backpressure

Specifications

For other materials or modifications, please consult TESCOM.

OPERATING PARAMETERS

Pressure rating per criteria of ANSI/ASME B31.3

<p>Maximum Inlet Pressure Air Loaded: 500 psig / 34.5 bar Dome Loaded: 5500 psig / 379 bar Spring Loaded: 500 psig / 34.5 bar</p> <p>Design Proof Pressure 150% of maximum operating</p> <p>Maximum Air Operator Pressure 100 psig / 6.9 bar</p> <p>Operating Temperature¹ -40°F to 165°F / -40°C to 74°C</p> <p>Internal Leakage Bubble-tight</p> <p>Flow Capacity (main valve) $C_v = 5.0$</p>

MEDIA CONTACT MATERIALS

<p>Body 303 and 316 Stainless Steel</p> <p>Seat Glass Filled Peek, Vespel® SP1</p> <p>O-Rings Buna-N, Viton®, Ethylene Propylene</p> <p>Back-up Rings Teflon®</p> <p>Remaining Parts 303 Stainless Steel</p>
--

OTHER

<p>Cleaning CGA 4.1 and ASTM G93</p> <p>Weight (approximately) 30 lbs / 13.6 kg</p>

1. Operating temperature range dependent on O-ring material.
 Teflon®, Viton® and Vespel® are registered trademarks of E.I. du Pont de Nemours and Company.



SPRING LOADED

TESCOM 54-2700 Series high flow backpressure regulator. The soft seat allows for hydraulic or pneumatic service. Optional with air load for use with the TESCOM ER3000 Electropneumatic Controller.

Applications

- Process control
- High flow pump discharge control
- Hydraulic test stands

Features and Benefits

- Available in air, dome, and spring loaded versions
- Compatible with TESCOM ER3000 Electropneumatic Controller (air load only)
- High flow: $C_v = 5.0$
- 500 or 5500 psig / 34.5 or 379 bar maximum controlled pressure range

54-2700 Series Regulator Drawing

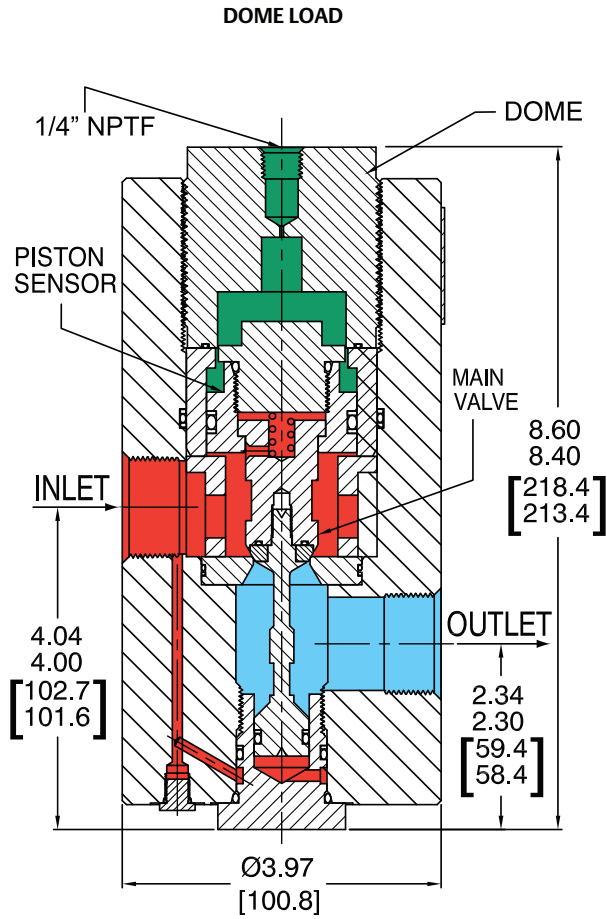

SPRING LOAD

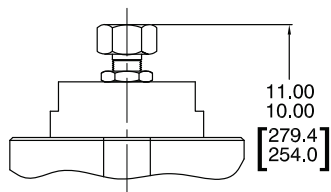

AIR LOAD

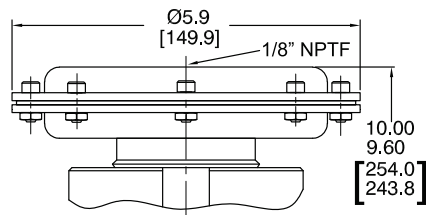

All dimensions are reference & nominal
Metric [millimeter] equivalents are in brackets

54-2700 Series Regulator Flow Charts

For more information on how to read flow curves, please refer to the Flow Curves and Calculations document (debul2007x012) in the TESCOM catalog or on www.tescom.com.

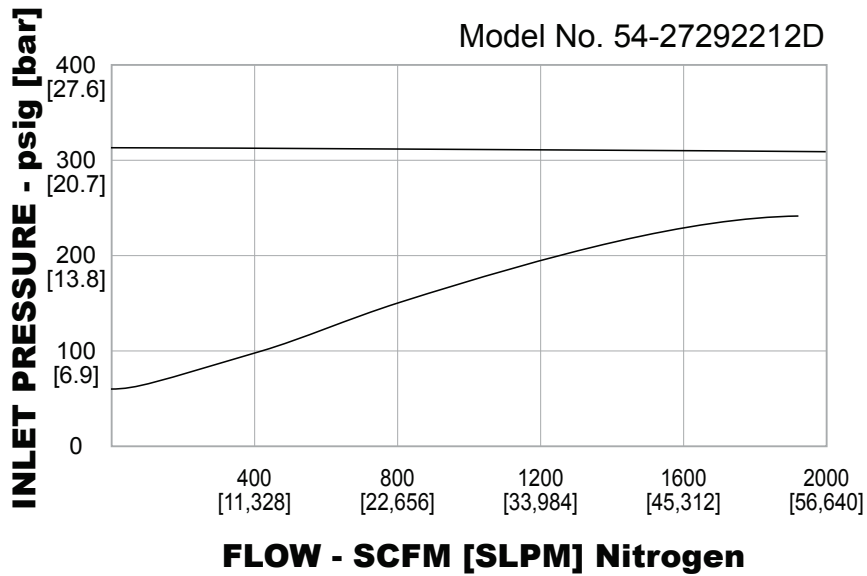
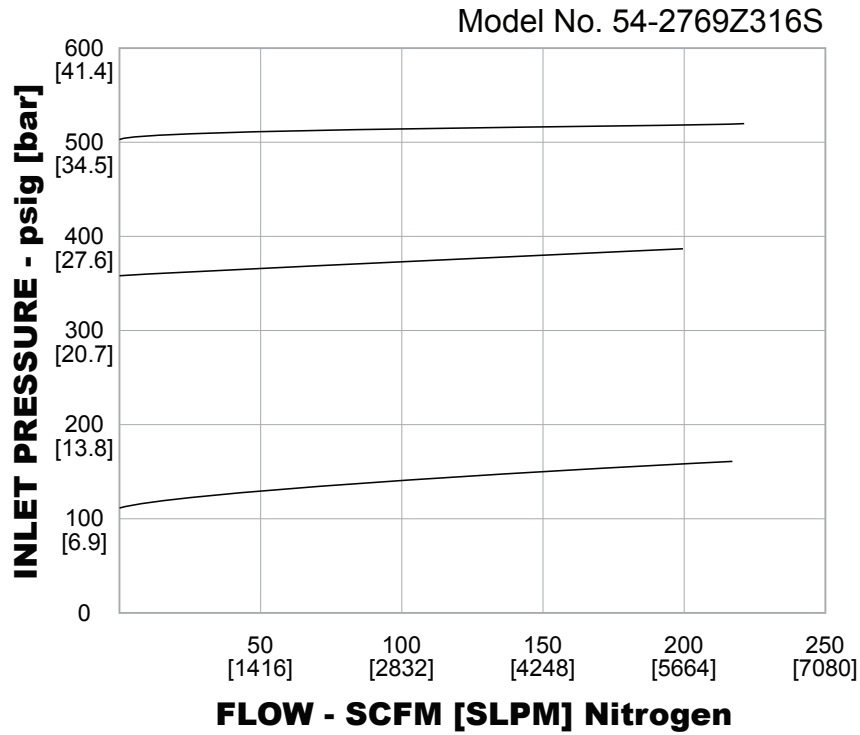

54-2700 Series Regulator Part Number Selector

Repair Kits, Accessories & Modifications may be available for this product. Please contact TESCOM for more information.

Example for selecting a part number:

54-27 2 9 Z 2 16 A

BASIC SERIES	BODY MATERIAL	CONTROL PRESSURE	SOFT GOODS MATERIAL			INLET AND OUTLET PORT TYPE	PORT SIZE	LOADING OPTIONS
			O-RINGS	SEAT	TEMPERATURE			
54-27	2 – 303 Stainless Steel	9 – 500 psig / 34.5 bar (5500 psig / 379 bar for dome load only)	T – Viton®	Glass Filled Peek	-15°F to 300°F -26°C to 149°C	1 – SAE* 2 – NPTF 3 – MS33649	16 – 1"	A – Air D – Dome S – Spring
	6 – 316 Stainless Steel		Z – Ethylene Propylene	Glass Filled Peek	-40°F to 250°F -40°C to 121°C			
			D – Buna-N	Glass Filled Peek	-40°F to 165°F -40°C to 74°C			
			V – Viton®	VespeI® SP1	-15°F to 300°F -26°C to 149°C			

*Body diameter is 4.50"