

ELECTRICAL ACTUATOR

TYPE 5630-015/030



GENERAL

MATERIAL:	ALUMINUM, POLYESTER POWDER COATED.
POWER SUPPLY:	230V/50/60HZ AC; 24V AC/DC
ENCLOSURE:	IP67
TEMPERATURE:	-20° C / +70° C
TRAVEL ANGLE:	90°
TORQUE:	150-300Nm
TORQUE LIMITER:	ELECTRONIC
DUTY RANGE:	S2 30 MIN
ISO FLANGE:	ISO 5211
DUTY RANGE:	S2 30 MIN
LIMIT SWITCH:	4 X SPDT MECHANICAL SWITCH
SPACE HEATER:	7/10W
CABLE ENTRIES:	M25, MANUEL HANDWHEEL VISIBLE POSITION INDICATOR

OPTION

POSITIONER:	4 - 20mA
POTENTIOMETER:	1 K Ω - 10 K Ω
BATTERY BACKUP:	1 PHASE 50/60 HZ
CLASS:	IP68
VOLTAGE:	3 PHASE 400VAC
TORQUE:	500-3000Nm
DUTY RANGE:	S4 70% MAX. 300-1600 START/HOUR (INTERMITTENT OPERATION)
DESIGN:	ATEX

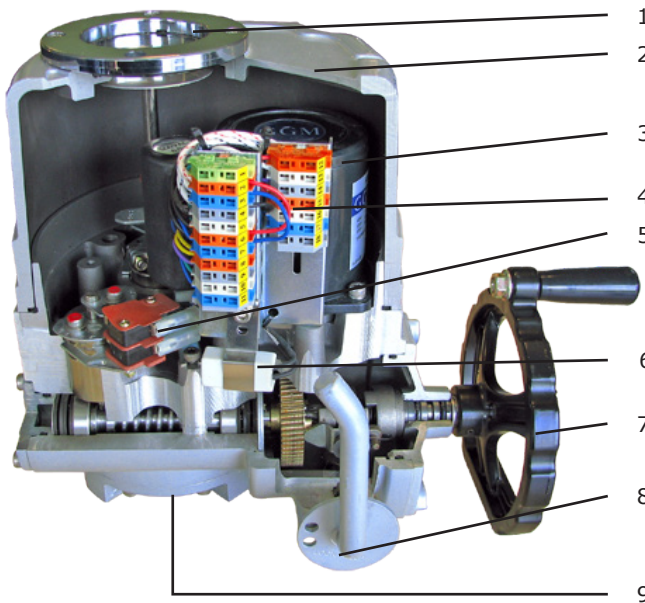

POS	DESCRIPTION	MATERIALS
1	POSITION INDICATOR	GLASS / ALUMINUM
2	BODY	POLYESTERCOATED ALUMINIUM
3	MOTOR	
4	TERMINAL BLOCK	POLYAMID
5	LIMIT SWITCH / CAM	SPDT / POLYCARBONAT
6	SPACE HEATER	CERAMIC
7	HAND WHEEL	POLYESTERCOATEDALUMINIUM
8	MANUAL OVERRIDE	POLYESTERCOATEDALUMINIUM
9	ISO MOUNTING PLATE	POLYESTERCOATEDALUMINIUM

DESCRIPTION

- **Rugged and compact design**, ideal for bigger valves up to 300Nm.
- **Metal gearbox** insures long life time.
- **Double square connection** provides greater flexibility regarding mounting.
- **Thermostatic heater** prevents condensation inside the casing.
- **Very simple installation** due to ISO 5211 mounting flange.
- **Casing in anodized aluminum** exterior is polyester coated on the outside in grey colour.
- **Good visual indication** of open and closed valve.
- **Manual operation** via buttom hand wheel.
- **Power supply** can be delivered as 24DC, 24AC, 230VAC. Also available with positioner control.

DIMENSION 015-030

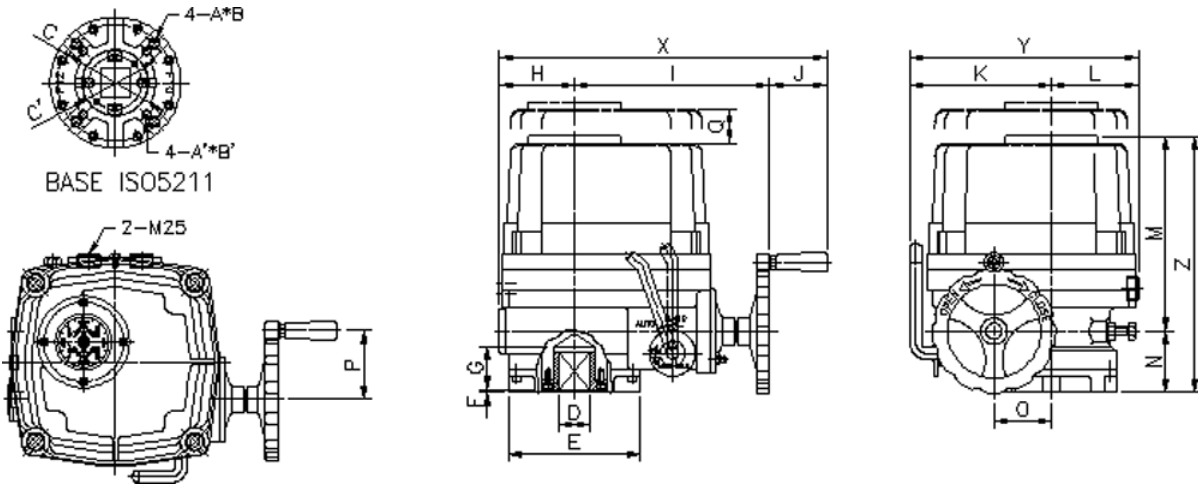

MODEL	ISO 5211	A	D	E	F	G	H	I	J	K	L	M	N	O	P	Q	X	Y	Z
	ØC	B																	
015	F07/F10	M8/M10	17	125	3	42	73	200	65	142	87	192	68	54	78	160	338	229	268
	Ø70/Ø102	12/15																	
030	F10/F12	M10/M12	22	148	3	49	82	221	65	160	99	221	69	65	78	180	368	259	304
	Ø102/Ø125	15/18																	

ACTUATOR DATA

MODEL	TORQUE [Nm]	OPERATION TIME 90° [SEC]	ISO 5211	POWER CONSUMPTION 50/60Hz [A]		DUTY CYCLE		WEIGHT [KG]
				230V AC	24V AC/DC	ON/OFF [S2]	MODULATING [S4]	
015	150	25	F07/F10	0,84	-	30 min.	70%	16,6
030	300	31	F10/F12	0,92	.	30 min.	70%	22,0

TYPICAL WIRE DIAGRAM

