

RECTUS Series 26KA

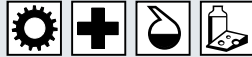

Nominal Diameter

40 mm² = **7.2**

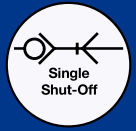

Stainless Steel

Technical Description

Euro-Coupling-System made of AISI 303 for corrosion resistant applications. Plug Profile interchangeable to Euro-Profile.

Advantages

Single handed operation.

Working Pressure

PB = 35 bar, maximum static working pressure with safety factor of 4 to 1.

Interchangeability

RECTUS 25
European Profile

Working Temperature*

-15°C up to +100°C (FKM)
depending on the medium.

*At a temperature below -15°C and above +100°C special seals are available on request.

Chart

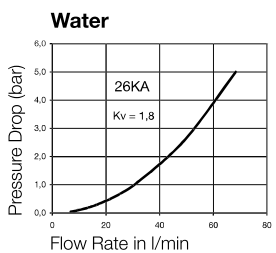
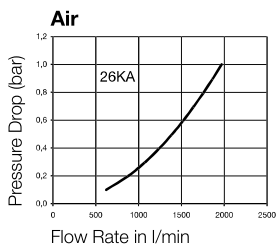

Material

Coupling

Back Body
Valve Body
Sleeve
Valve
Spring
Balls, Pins
Seals
Distance Sleeve

AISI 303

AISI 303
AISI 303
AISI 303
AISI 303
AISI 301
AISI 316
FKM
PTFE

Plug

Plug

AISI 303

90% of actual size



You will find the following alternative versions in our current catalogue on page:

- ▶ Brass/Steel Single Shut-off P. 66
- ▶ Brass/Steel Double Shut-off P. 132
- ▶ Safety Self-Venting P. 278

Couplings

RECTUS Series 26KA

	Connection A	Hex SW	L mm	D mm	L1 mm	L2 mm	Hex1 SW1	B mm	G mm	Version	Part Number	DS
<p>Male Thread</p>	G 1/4	19	55,5	28	10,5					AISI 303	26KA AW13 RVX	■□
	G 3/8	19	53,5	28	9					AISI 303	26KA AW17 RVX	■□
	G 1/2	24	56,5	28	12					AISI 303	26KA AW21 RVX	■□
<p>Female Thread</p>	G 1/4	19	51,5	28	10					AISI 303	26KA IW13 RVX	■□
	G 3/8	19	53,5	28	9					AISI 303	26KA IW17 RVX	■□
	G 1/2	24	56,5	28	12					AISI 303	26KA IW21 RVX	■□

⚠ Please consider our security advices on the pages 12/13 ⚠

Low Pressure

Couplings

RECTUS Series 26KA

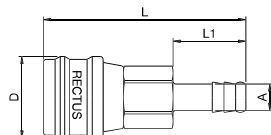

Hose Barb

Connection A	Hex SW	L mm	D mm	L1 mm	L2 mm	Hex1 SW1	B mm	G mm	Version	Part Number	DS
6 mm	19	69,5	28	25					AISI 303	26KA TF06 RVX	■□
8 mm	19	69,5	28	25					AISI 303	26KA TF08 RVX	■□
9 mm	19	69,5	28	25					AISI 303	26KA TF09 RVX	■□
10 mm	19	69,5	28	25					AISI 303	26KA TF10 RVX	■□
13 mm	19	69,5	28	25					AISI 303	26KA TF13 RVX	■□

Plugs

RECTUS Series 25SF

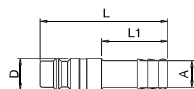

Hose Barb

Connection A	Hex SW	L mm	D mm	L1 mm	L2 mm	Hex1 SW1	B mm	G mm	Version	Part Number	DS
6 mm		48	12	25					AISI 303	25SF TF06 RXX	■
									AISI 316 L	25SF TF06 EXX	■
8 mm		48	12	25					AISI 303	25SF TF08 RXX	■
									AISI 316 L	25SF TF08 EXX	■
9 mm		48	12	25					AISI 303	25SF TF09 RXX	■
									AISI 316 L	25SF TF09 EXX	■
10 mm		48	12	25					AISI 303	25SF TF10 RXX	■
									AISI 316 L	25SF TF10 EXX	■
13 mm		48	15	25					AISI 303	25SF TF13 RXX	■
									AISI 316 L	25SF TF13 EXX	■

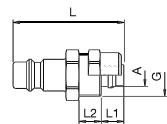

Plastic Hose Connection

4 x 6 mm		34	12	7	6			M 10 x 1	AISI 303	25SF KO06 RXX	■□
									AISI 316 L	25SF KO06 EXX	■□
6 x 8 mm		34	12	7	6			M 12 x 1	AISI 303	25SF KO08 RXX	■□
									AISI 316 L	25SF KO08 EXX	■□
8 x 10 mm	17	42		9	8			M 16 x 1	AISI 303	25SF KO10 RXX	■□
9 x 12 mm	17	42		9	8			M 16 x 1	AISI 303	25SF KO12 RXX	■
									AISI 316 L	25SF KO12 EXX	■□

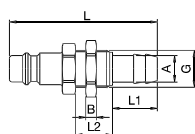
Panel Mount,
Hose Barb

6 mm	14	56		17	14	17	4	M 12 x 1	AISI 303	25SF TS06 RXX	■□
8 mm	14	56		17	14	17	4	M 12 x 1	AISI 303	25SF TS08 RXX	■□
10 mm	17	56		17	14	19	4	M 14 x 1	AISI 303	25SF TS10 RXX	■□

DS = Delivery Status

■ in stock

■□ on short call

■□ medium term delivery

Plugs

RECTUS Series 25SF

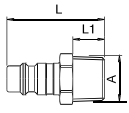
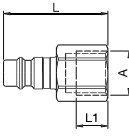
Connection A	Hex SW	L mm	D mm	L1 mm	L2 mm	Hex1 SW1	B mm	G mm	Version	Part Number	DS	
 <p>Male Thread</p>	G 1/8	14	31	7					AISI 303	25SF AW10 RXX	■	
									AISI 316 L	25SF AW10 EXX	□	
	G 1/4	17	33	9						AISI 303	25SF AW13 RXX	■
										AISI 316 L	25SF AW13 EXX	■
	G 3/8	19	33	9						AISI 303	25SF AW17 RXX	■
										AISI 316 L	25SF AW17 EXX	■
	G 1/2	24	38	12						AISI 303	25SF AW21 RXX	■
										AISI 316 L	25SF AW21 EXX	■
	M 18 x 1,5	22	37	11						AISI 303	25SF AM18 RXX	■
	 <p>Female Thread</p>	G 1/8	14	30	7					AISI 303	25SF IW10 RXX	■
										AISI 316 L	25SF IW10 EXX	■
		G 1/4	17	33	10						AISI 303	25SF IW13 RXX
AISI 316 L											25SF IW13 EXX	■
G 3/8		19	33	10						AISI 303	25SF IW17 RXX	■
										AISI 316 L	25SF IW17 EXX	■
G 1/2		24	35	12						AISI 303	25SF IW21 RXX	■
										AISI 316 L	25SF IW21 EXX	□
M 14 x 1,5		17	33	10						AISI 303	25SF IM14 RXX	□
M 14 x 1,5		17	33	10						AISI 303	25SF IM14 RXX	■
M 14 x 1,5		17	33	13						AISI 303	25SF IM14 RXX	□