

**TFK - Tulejka zaciskowa do węży wykonana ze stali nierdzewnej**

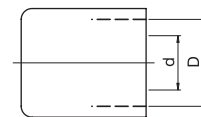

Kod	d	D			
TFK1610	10	16			
TFK1810	10	18			
TFK1913	13	19			
TFK2013	13	20			
TFK2313	13	23			
TFK2919	19	29			

**TFK...**



Kod	D		
TFP 1000	średnice od 10 - 36 mm		

**TFP...**

Urządzenie TFP 100 służy do ręcznego zaciskania tulejek typu TFK na przewodach niskociśnieniowych w zakresie średnic zewnętrznych od 10 do 36 mm

**Opaska typu NORMA**



Kod	D	d			
TFB0814	8-12	8			
TFB1016	10-17	10			
TFB1318	12-22	13			
TFB2232	22-32	19			

**TFB...**

**Tuleja do węża, gwint zewnętrzny**

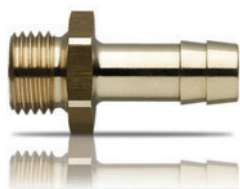

Kod	A	D	L	L1	SW
TFM810	M8 x 0,75	9 mm	33,5	7	11
TFM1010	M10 x 1	9 mm	33,5	7	11
TF1/810	1/8"	9 mm	33	7	14
TF1/410	1/4"	10 mm	35	9	17
TFM1213	M12 x 1,5	13 mm	40	9	15
TF1/413	1/4"	13 mm	42	9	17
TFM1413	M14 x 1,5	13 mm	43	10	17
TFM1613	M16 x 1,5	13 mm	40	9	17
TF3/813	3/8"	13 mm	42	9	19
TFM2419	M24 x 1,5	19 mm	56	16	27
TF1/219	1/2"	19 mm	54	12	24
TF3/419	3/4"	19 mm	60	16	32

**TF...**

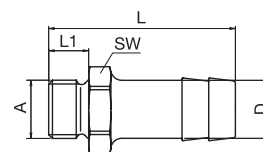

**Tuleja do węża Push-on, gwint zewnętrzny**

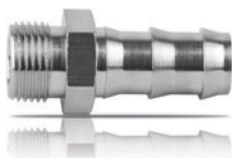

Kod	A	D	L	L1	SW
TP1/410	1/4"	10 mm	42	7	17
TP1/413	1/4"	13 mm	43	8	17
TP3/813	3/8"	13 mm	47	8	19
TP1/213	1/2"	13 mm	49	10	22

**TP...**

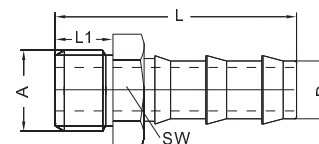

**Tuleja do węża, gwint wewnętrzny**



Kod	A	D	L	L1	SW
TFI1/810	1/8"	10 mm	33	8	14
TFI1/410	1/4"	10 mm	33	8	17
TFIM1410	M14 x 1,5	10 mm	32	10	17
TFI1/413	1/4"	13 mm	39	8	17
TFIM1613	M16 x 1,5	13 mm	40	10,5	22
TFI3/813	3/8"	13 mm	40	8	19

**TFI...**

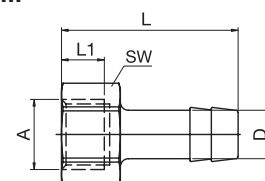

## Tuleja do węży z nakrętką obrotową



Kod	A	D	L	L1	SW
TFC14	M14 x 1,5	9	39,5	22	17
TFC1/4	G 1/4	9	39,5	22	17
TFC16	M16 x 1,5	13	39	25	22
TFC3/8	G 3/8	13	39	25	22
TFC1/2	G 1/2	13	45	25	24
TFC24	M24 x 1,5	19	52	32	30
TFC3/4	G 3/4	19	52	32	32

## TFC...

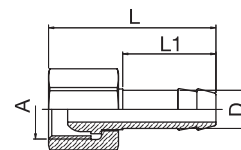

## Kolanko do węży, gwint zewnętrzny



Kod	A	D	L	L1	SW
TFVM810	M8 x 0,75	10 mm	27	9	11
TFVM1010	M10 x 1	10 mm	27	9	11
TFV1/810	1/8"	10 mm	27	9	11
TFV1/410	1/4"	10 mm	34	11	15
TFV1/413	1/4"	13 mm	34	11	15
TFVM1413	M14 x 1,5	13 mm	34	11	15
TFV3/813	3/8"	13 mm	35	12	17
TFVM2419	M24 x 1,5	19 mm	47	16	24
TFV1/219	1/2"	19 mm	47	16	24

## TFV...

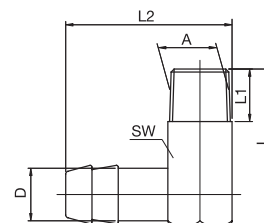

## Łącznik gwint zewnętrzny



Kod	A	A1	L	L1	L2	SW
TFD14	M14 x 1,5	M14 x 1,5	23	9	9	17
TFD14-1/4	M14 x 1,5	G 1/4	23	9	9	17
TFD1/4	G 1/4	G 1/4	23	9	9	17
TFD16	M16 x 1,5	M16 x 1,5	23	9	9	19
TFD16-3/8	M16 x 1,5	G 3/8	23	9	9	19
TFD3/8	G 3/8	G 3/8	23	9	9	19
TFD1/2-14	G 1/2	M14 x 1,5	27	12	9	22
TFD1/2-16	G 1/2	M16 x 1,5	27	12	9	22
TFD1/2	G 1/2	G 1/2	30	12	12	22
TFD24-1/2	M24 x 1,5	G 1/2	36	16	12	27
TFD3/4	G 3/4	G 3/4	40	16	16	27
TFD3/4-24	G 3/4	M24 x 1,5	40	16	16	27

## TFD...

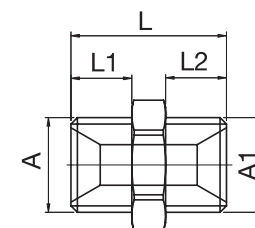

## Redukcja krótka



Kod	A	A1	L	L1	SW
TF1/4-1/8	G 1/4	G 1/8	11	7	17
TF14-10	M14 x 1,5	M10 x 1	11	7	17
TF3/8-1/4	G 3/8	G 1/4	13	9	19
TF18-14	M18 x 1,5	M14 x 1,5	14	9	22
TF1/2-3/8	G 1/2	G 3/8	18	12	24
TF3/7-1/2	G 3/4	G 1/2	24	16	27
TF24-16	M24 x 1/5	M16 x 1,5	24	16	27

## TF...

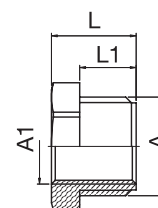

## Korek stożkowy / cylindryczny



Kod - stoż.	Kod - cyl.	A	L	SW
TFRM8	TFRM8C	M8 x 0,75	8	4
TFRM10	TFRM10C	M10 x 1	8	5
TFR1/8	TFR1/8C	1/8"	8	5
TFRM12	TFRM12C	M12 x 1,5	8	6
TFR1/4	TFR1/4C	1/4"	10	7
TFRM14	TFRM14C	M14 x 1,5	10	7
TFR3/8	TFR3/8C	3/8"	10	8
TFR1/2	TFR1/2C	1/2"	10	10

## TFR.../C

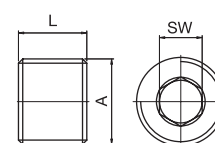

## Korek z kołnierzem z gwintem cylindrycznym



Kod	A	D	L	L1	SW
TFLM10	M10 x 1	14	11	8	5
TFLR1/8	G 1/8	14	11	8	5
TFLM12	M12 x 1,5	17	15	12	6
TFLR1/4	G 1/4	18	15	12	6
TFLM14	M14 x 1,5	19	15	12	6
TFLR3/8	G 3/8	22	15	12	8
TFLR1/2	G 1/2	26	18	14	10

## TFL...

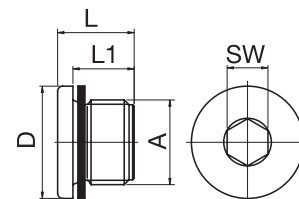

## Korek



Kod	A	D	L	L1
TFVS6	M3	6	11,5	3,5
TFVS8	M4	8	11,5	3,5
TFVS10	M6	10	14	4
TFVS12	M6	12	14	4
TFVS16	M8	16	16	4

## TFVS...

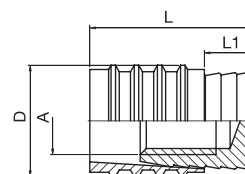

## Przedłużka z tuleją do węża



Kod	D	D1	d	L	SW
TF10/120	10 mm	10	6	120 mm	11
TF10/240	10 mm	10	8	240 mm	11
TF13/150	13 mm	14	9	150 mm	15
TF13/300	13 mm	14	9	300 mm	15

## TF...

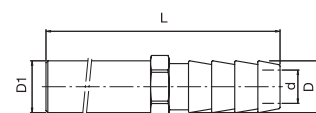

## Przedłużka dwustronnie gwintowana



Kod	A	d	L
TF1/8/50	R1/8"	6	50 mm
TF1/8/100	R1/8"	6	100 mm
TF1/8/150	R1/8"	6	150 mm
TF1/8/200	R1/8"	6	200 mm
TF1/4/50	R1/4"	9	50 mm
TF1/4/100	R1/4"	9	100 mm
TF1/4/150	R1/4"	9	150 mm
TF1/4/200	R1/4"	9	200 mm
TF3/8/100	R3/8"	12	100 mm
TF3/8/150	R3/8"	12	150 mm
TF3/8/200	R3/8"	12	200 mm

## TF...

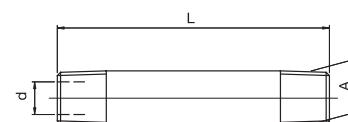

## Rotometr



Kod	A	A1	L	Uszczelnienie	Przepływ
5ROT07AW21IW26M	G 1/2"	G 3/4"	81	NBR	2-8 l/min
5ROT10AW33AW33M	G 1"	G 1"	104	NBR	4-15 l/min
5ROT12AW33AW33M	G 1"	G 1"	104	NBR	8-30 l/min

### Parametry techniczne:

Temperatura pracy: 0°C do + 100°C

Ciśnienie robocze: 0-10 bar

Materiał: msiądz