



## ART. 201



Raccordo diritto maschio conico  
Taper straight male adaptor

CODICE	ØD	A	B	L			
2010418	4	G1/8	8	27	10	10	100
2010618	6	G1/8	8	28	12	12	100
2010614	6	G1/4	11	32,5	12	14	100
2010818	8	G1/8	8	29,5	14	12	100
2010814	8	G1/4	11	33	14	14	100
2010838	8	G3/8	11,5	33	14	17	50
2011014	10	G1/4	11	37,5	19	17	50
2011038	10	G3/8	11,5	38	19	17	50
2011012	10	G1/2	14	40,5	19	22	25
2011238	12	G3/8	11,5	39	22	19	25
2011212	12	G1/2	14	41	22	22	25
2011412	14	G1/2	14	42,5	27	22	25
2011512	15	G1/2	14	42,5	27	22	25
2011612	16	G1/2	14	42	30	24	10
2011812	18	G1/2	14	43	32	26	10

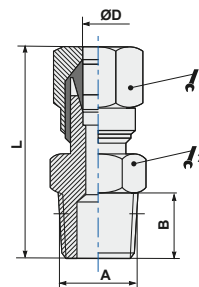

## ART. 201Z

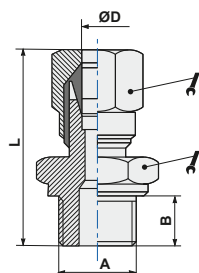

Raccordo diritto maschio cilindrico  
Parallel straight male adaptor

CODICE	ØD	A	B	L			
201Z0418	4	G1/8	6	25	10	14	100
201Z0618	6	G1/8	6	26	12	14	100
201Z0614	6	G1/4	8	29,5	12	17	100
201Z0814	8	G1/8	6	27,5	14	14	100
201Z0818	8	G1/4	8	30	14	17	50
201Z0838	8	G3/8	9	30,5	14	19	50
201Z1014	10	G1/4	8	34,5	19	17	50



## ART. 202

Raccordo diritto femmina  
Female straight adaptor

CODICE	ØD	A	B	L			
2020418	4	G1/8	8	24,5	10	14	100
2020618	6	G1/8	8	26	12	14	100
2020614	6	G1/4	11	30,5	12	17	100
2020818	8	G1/8	8	26,5	14	14	50
2020814	8	G1/4	11	31	14	17	50
2020838	8	G3/8	11,5	31	14	20	50
2021014	10	G1/4	11	35,5	19	17	50
2021038	10	G3/8	11,5	36,5	19	20	25

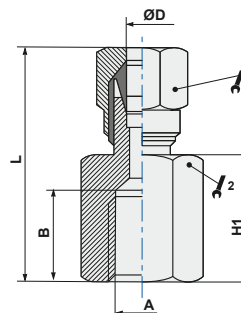

**ART. 203**

 Raccordo diritto intermedio  
*Straight connector*

CODICE	ØD	L					
2030400	4	33,5			10	10	50
2030600	6	36,5			12	12	50
2030800	8	38,5			14	14	50
2031000	10	47,5			19	17	25
2031200	12	50,5			22	19	25
2031400	14	55,5			27	24	10
2031500	15	55,5			27	24	10

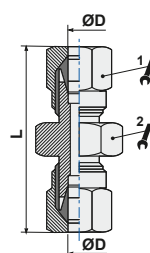
**ART. 204**

 Raccordo passaparete  
*Bulkhead adaptor*

CODICE	ØD	L					
2040600	6	51,5			12	14	50
2040800	8	55,5			14	16	50
2041000	10	62,5			19	19	25
2041200	12	64,5			22	22	10
2041400	14	69,5			27	25	5
2041500	15	69,5			27	25	5

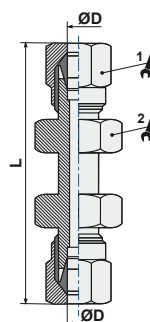
**ART. 205**

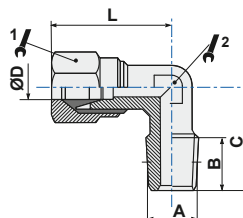

 Raccordo ad L  
*L male adaptor*

CODICE	ØD	A	B	C	L				
2050418	4	G1/8	8	16	21		10	9	100
2050618	6	G1/8	8	16	22		12	9	100
2050614	6	G1/4	11	20	24,5		12	11	100
2050818	8	G1/8	8	17	24		14	11	100
2050814	8	G1/4	11	20	24		14	11	100
2050838	8	G3/8	11,5	24	27		14	13	50
2051014	10	G1/4	11	23,5	32		19	13	50
2051038	10	G3/8	11,5	24	32		19	13	25
2051012	10	G1/2	14	28,5	34		19	15	25
2051238	12	G3/8	11,5	25,5	34,5		22	15	25
2051212	12	G1/2	14	28,5	34,5		22	15	25
2051412	14	G1/2	14	30	38		27	17	25
2051512	15	G1/2	14	30	38		27	17	10
2051612	16	G1/2	14	31,5	39,5		30	19	10
2051812	18	G1/2	14	34	44		32	22	10



## ART. 206

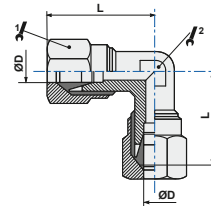

Raccordo ad L intermedio  
*L connector*

CODICE	ØD	L						
2060400	4	21				10	9	100
2060600	6	23				12	9	50
2060800	8	24				14	11	50
2061000	10	32				19	13	25
2061200	12	34,5				22	15	10
2061400	14	38				27	17	10
2061500	15	38				27	17	10
2061600	16	39,5				30	19	10



## ART. 207

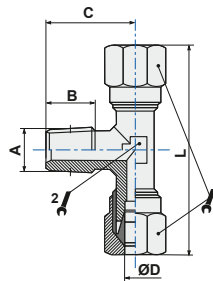

Raccordo a T centrale  
*Centre male T adaptor*

CODICE	ØD	A	B	C	L				
2070418	4	G1/8	8	16	42		10	9	100
2070618	6	G1/8	8	16	46		12	9	50
2070614	6	G1/4	11	20	48		12	11	50
2070818	8	G1/8	8	17	48		14	11	50
2070814	8	G1/4	11	20	48		14	11	25
2070838	8	G3/8	11,5	24	54		14	13	25
2071014	10	G1/4	11	23,5	64		19	13	25
2071038	10	G3/8	11,5	24	64		19	13	25
2071238	12	G3/8	11,5	25,5	69		22	15	10
2071212	12	G1/2	14	28,5	69		22	15	10



## ART. 208

Raccordo a T laterale  
*Off-set male T adaptor*

CODICE	ØD	A	B	C	L				
2080418	4	G1/8	8	37	21		10	9	100
2080618	6	G1/8	8	39	23		10	9	50
2080614	6	G1/4	11	44,5	24,5		12	11	50
2080818	8	G1/8	8	41	24		14	11	50
2080814	8	G1/4	11	44	24		14	11	25
2080838	8	G3/8	11,5	51	27		14	13	25
2081014	10	G1/4	11	55,5	32		19	13	25
2081038	10	G3/8	11,5	56	32		19	13	25
2081238	12	G3/8	11,5	60	34,5		22	15	10
2081212	12	G1/2	14	63	34,5		22	15	10

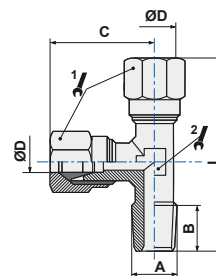

## ART. 209

Raccordo a T intermedio  
*T connector*

CODICE	ØD	C	L					
2090400	4	21	42			10	9	50
2090600	6	23	46			12	9	50
2090800	8	24	48			14	11	25
2091000	10	32	64			19	13	25
2091200	12	34,5	69			22	15	10

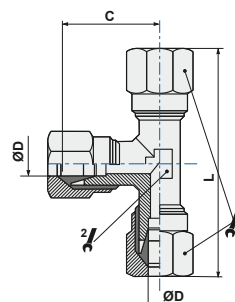

**ART. 210**

 Dado  
Nut

CODICE	ØD	A	H				
2100400	4	M8x1	11			10	100
2100600	6	M10x1	11,5			12	100
2100800	8	M12x1	12			14	100
2101000	10	M16x1,5	15,5			19	100
2101200	12	M18x1,5	15,5			22	100
2101400	14	M22x1,5	17,5			27	10
2101500	15	M22x1,5	17			27	10
2101600	16	M24x1,5	17,5			30	10
2101800	18	M26x1,5	18,5			32	10

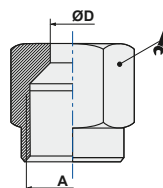
**ART. 211**

 Ogiva  
Ogive

CODICE	ØD	ØD1	H				
2110400	4	6	6				100
2110600	6	8	7				100
2110800	8	10	7				100
2111000	10	13	10				100
2111200	12	15	10				100
2111400	14	17	10				100
2111500	15	18	10				100
2111600	16	19	10				100
2111800	18	21	10,5				100

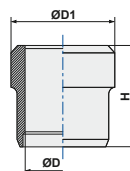
**ART. 212**

 Boccia di supporto  
Support bush

CODICE	ØD	ØD1	H				
2120200	2	3,5	8				100
2120250	2,5	3,9	10				100
2120400	4	5,5	12				100
2120600	6	7,5	13				100
2120800	8	9,5	14				100
2121000	10	11,5	16				100
2121200	12	13,5	16				100
2121250	12,5	14,5	17				100
2121400	14	15,5	18				100

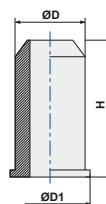
**ART. 216**

 Raccordo ad L orientabile  
Single banjo body

CODICE	ØD	G*	ØA	B	L		
2160418	4	1/8	9,8	14,5	24,5	10	50
2160618	6	1/8	9,8	14,5	26,5	12	50
2160614	6	1/4	13,2	14,5	28,5	12	50
2160818	8	1/8	9,8	14,5	25,5	14	50
2160814	8	1/4	13,2	14,5	28	14	50
2161014	10	1/4	13,3	14,5	32	17	25

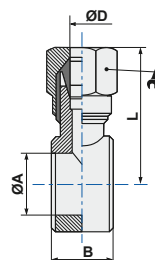
 (\*) G = filetto vite/asta  
 (\*) G = steam thread

**BREVE DESCRIZIONE**

I raccordi ad ogiva della nostra serie **200**, sono realizzati in Italia, a garanzia di elevati standard di qualità, secondo le normative ISO/DIN di riferimento, e rispondono alle seguenti specifiche tecniche e applicative.

**SHORT DESCRIPTION**

The compressed **200** series fittings are produced in Italy according to the reference ISO/DIN norms as warranty of high quality level and answer to the followings technical specifications and applications.

**SCHEMA TECNICA TECHNICAL SHEET**

FLUIDI UTILIZZABILI <i>EMPLOYABLE FLUIDS</i>		Aria compressa, acqua fino 100 °C (per altri fluidi contattare il nostro UT) <i>Compressed air, water up to 100 °C</i> <i>(for different fluid pls contact our Technical Dept.)</i>
APPLICAZIONI <i>APPLICATIONS</i>		Circuiti pneumatici, oleodinamici e idraulici. <i>Pneumatic, oleodynamic and hydraulic circuits.</i>
TUBI DI COLLEGAMENTO <i>CONNECTING TUBES</i>	plastici <i>plastic</i>	TPU, PE, PA, PET, PVC intrecciato, PTFE, FEP (solo con l'uso dell'anima di rinforzo interna) <i>TPU, PE, PA, PET, braided PVC, PTFE, FEP</i> <i>(with internal reinforcement included)</i>
	metallici <i>metal</i>	Rame, ottone, acciaio, alluminio, ecc. <i>Copper, brass, steel, aluminium, etc.</i>
FILETTATURE <i>THREAD TYPE</i>		BSP cilindrica UNI-ISO 228; BSPT conica UNI-ISO 7-DIN2999. <i>BSP parallell UNI-ISO 228; BSP tapered UNI-ISO 7-DIN2999.</i>
MATERIALI <i>MATERIALS</i>	corpi <i>bodies</i>	Ottone UNI EN 12164 CW614N (barra); UNI EN 12165 CW617N (stampato) <i>Brass UNI EN 12164 CW614N (bar); UNI EN 12165 CW617N (molded)</i>
	guarnizioni tenuta <i>seals</i>	NBR 70 DWGV-EN549 UL157 <i>NBR 70 DWGV-EN549 UL157</i>
	rondelle <i>washers</i>	Nylon/Alluminio <i>Aluminium/Nylon</i>