

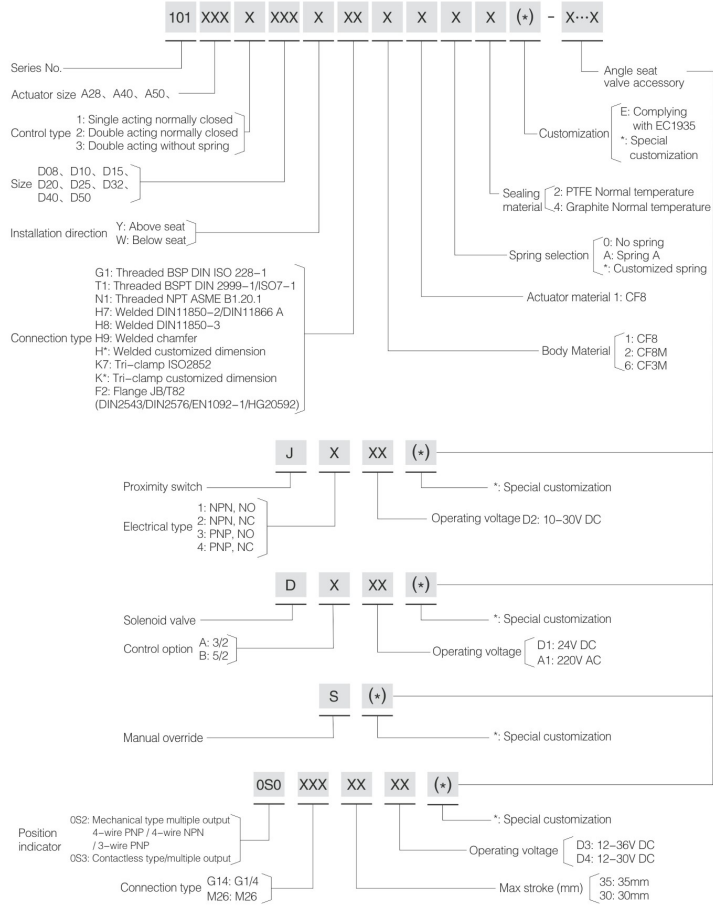

Y-type Angle Seat Valve

Order Instruction



107 Series Threaded Manual Angle Seat Valve



107 Series Welded Manual Angle Seat Valve

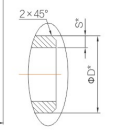
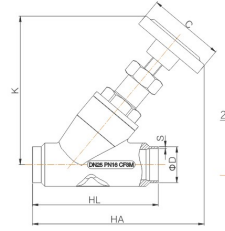
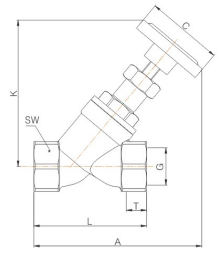

Main Dimension

Size	C	K	Threaded connection						Welded connection							
			G	T	A	L	SW	HA	HL	Chamfer		DIN11850-2		DIN11850-3		
										ØD*	S*	ØD	S	ØD	S	
DN8	62	115	1/4"	12	128	68	27	-	-	-	-	-	-	-	-	-
DN10	62	115	3/8"	12	128	68	27	-	-	-	-	-	-	-	-	-
DN15	62	115	1/2"	15	128	68	27	120	70	22	3.5	19	1.5	20	2	
DN20	62	120	3/4"	16	133	75	32	128	82	29	5	23	1.5	24	2	
DN25	62	125	1"	17	142	90	40	144	100	35	5	29	1.5	30	2	
DN32	62	146	1 1/4"	21	166	116	50	165	125	39	4	35	1.5	36	2	
DN40	62	148	1 1/2"	21	168	116	56	168	130	45	4.5	41	1.5	42	2	
DN50	62	155	2"	22	182	138	69	182	155	57	4	53	1.5	54	2	
DN65 <small>(Spain model)</small>	80	211	2 1/2"	26	226	178	85	270	270	75	5	70	2	-	-	

Note: * designates design dimension (the actual dimension may vary)



Y-type Angle Seat Valve

107 Series
Tri-clamp Manual
Angle Seat Valve



107 Series
Flanged Manual
Angle Seat Valve

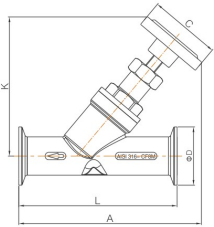

Tri-clamp connection

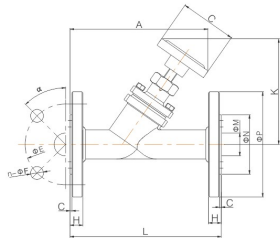

Flange connection

Main Dimension

Size	C	Tri-clamp connection					Flange connection									
		K	ΦD	L	A	K	A	L	C	H	ΦE	n-ΦF	ΦM	ΦN	ΦP	α
DN15	62	113	34	80	132	116	136	130	2	14	65	4-14	16	45	95	45°
DN20	62	122	50.5	130	147	122	157	150	2	14	75	4-14	19	56	105	45°
DN25	62	126	50.5	130	156	127	157	160	2	14	85	4-14	26	65	115	45°
DN32	62	142	50.5	146	174	147	162	180	2	16	100	4-18	31	78	140	45°
DN40	62	141	64	160	185	149	181	200	3	16	110	4-18	38	84	150	45°
DN50	62	152	64	175	195	156	210	230	3	16	125	4-18	54	100	165	45°
DN65 Square bonnet	80	200	91	278	266	201	272	290	3	18	145	4-18	71	120	185	45°

Technical Specification

- Operating pressure: 0-16bar (0-232psi)
- Body material: CF8/CF8M/CF3M and other special materials
- Seal material: PTFE
- Applicable medium: Water, Alcohol, Oil, Fuel, Steam, Neutral gas or Liquid, organic solvent, weak acid or weak base solution
- Fluid temperature: -10°C — +180°C
+25°C — +220°C
- Ambient temperature: -10°C — +80°C
- Maximum fluid viscosity: 600m²/s
- Connection type: Threaded, Welded, Tri-clamp, Flange
- Leakage class: DIN EN 12266 Class A



Adjustable seat

Note: Adjustable seat can be installed to achieve manual flow adjustment.

Order Instruction

