



Y-type Angle Seat Valve

- 120 Series Threaded Pneumatic Angle Seat Valve
- 120 Series Welded Pneumatic Angle Seat Valve
- 120 Series Tri-clamp Pneumatic Angle Seat Valve
- 120 Series Flanged Pneumatic Angle Seat Valve



Technical Specification

- Operating pressure: 0–16bar (0–232psi)
- Control pressure: 3–8bar (43.5–116psi)
- Control fluid: Filtered compressed air or neutral gas
- Body material: CF8/CF8M/CF3M and other special materials
- Seal material: PTFE
- Actuator material: CF8 (28mm–90mm Actuator), AL (125mm Actuator)
- Actuator size: 28mm, 40mm, 50mm, 63mm, 90mm, 125mm
- Applicable fluid: Water, Alcohol, Oil, Fuel, Steam, Neutral gas or Liquid, Organic solvent, Acid and lye
- Fluid viscosity: Max 600mm²/s
- Fluid temperature: –10°C — +180°C, +25°C — +220°C
- Ambient temperature: –10°C — +80°C
- Control type: Single acting normally closed, Single acting normally open, Double acting normally closed, Double acting without spring
- Connection type: Threaded (BSP, BSPT, NPT), Welded, Tri-clamp, Flanged
- Leakage class: EN 12266 Class A

Advantages

- New sealing structure can reduce residues and be easy to clean.
- High flow rate, low flow resistance, and no water hammer.
- Y-shaped valve body design, increasing flow by 30%.
- Ultra long service life.
- Valve rod auto-correction and self-lubricating.
- Stainless steel actuator, better performance in harsh environment and can rotate 360°.

Order Instruction

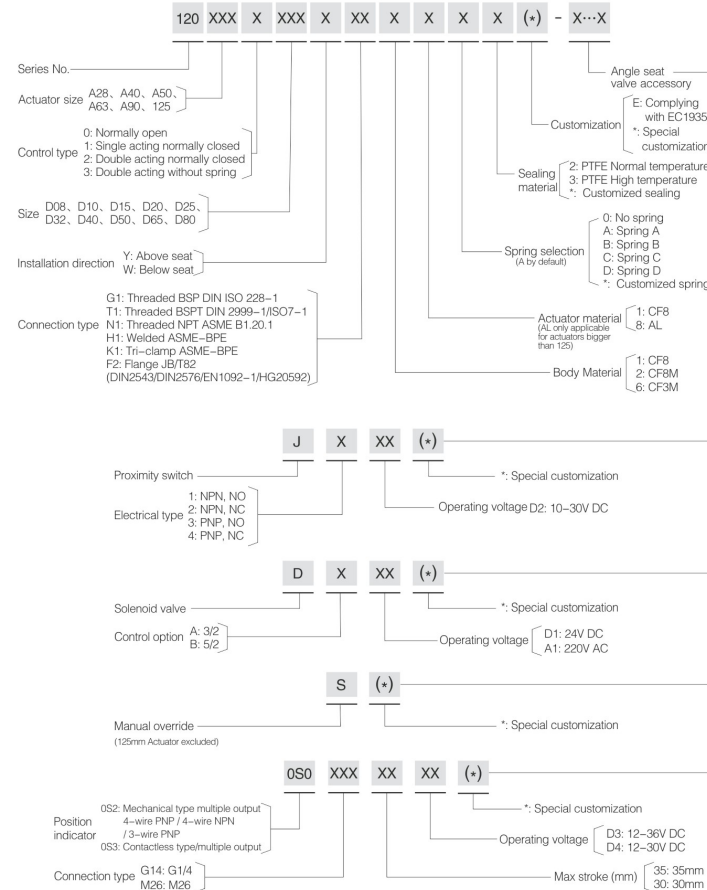

All the actuators except 28mm can be customized with accessory.



Y-type Angle Seat Valve

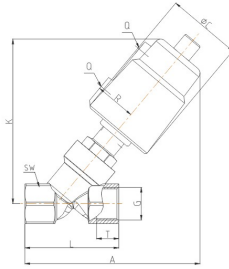

Threaded Connection

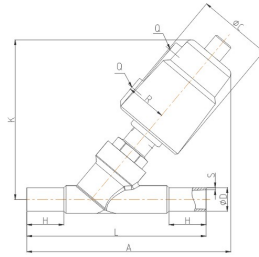

Welded Connection

Main Dimension (Threaded Connection)

Size	Actuator (mm)	Q	φC	R	K	A	Kv (m ³ /h)	G	T	L	SW
DN8	28	1/8"	42	21	110	117	1.8	1/4"	12	65	27
	40	1/8"	50.5	27	125	131	2.2				
	50	1/8"	60	33	139	143	2.2				
DN10	28	1/8"	42	20	110	117	2	3/8"	14	65	27
	40	1/8"	50.5	27	125	131	3.9				
	50	1/8"	60	33	139	143	3.9				
DN15	28	1/8"	42	20	110	117	2.2	1/2"	16	65	27
	40	1/8"	50.5	27	125	131	4.3				
	50	1/8"	60	33	139	143	4.3				
DN20	50	1/8"	60	33	141	146	7.6	3/4"	18	75	32
	50	1/8"	60	33	145	155	7.6				
DN25	63	1/8"	75	41	167	177	15.8	1"	20	90	40
	63	1/8"	75	41	180	193	15.8				
	90	1/8"	106	55	227	235	15.8				
DN32	63	1/8"	75	41	180	197	26.0	1 1/4"	22	110	50
	90	1/8"	106	55	227	235					
	63	1/8"	75	41	180	197					
DN40	90	1/8"	106	55	228	239	32.0	1 1/2"	24	120	56
	63	1/8"	75	41	187	215					
	90	1/8"	106	55	235	258					
DN50	90	1/8"	106	55	235	258	52.0	2"	26	150	69
	125AL	1/4"	170	85	300	312					

Main Dimension (Welded Connection)

Size	Actuator (mm)	Q	φC	R	K	A	Kv (m ³ /h)	L	H	ASME BPE	
										φD	S
DN15	28	1/8"	42	21	112	143	1.3	135	30	12.7	1.65
	40	1/8"	50.5	27	127	155	1.7				
	50	1/8"	60	33	140	166	1.7				
DN20	50	1/8"	60	33	138	170	5.8	145	30	19.05	1.65
	50	1/8"	60	33	146	178	5.8				
DN25	63	1/8"	75	41	168	200	11.8	152	30	25.4	1.65
	63	1/8"	75	41	177	216	11.8				
	90	1/8"	106	55	225	258	11.8				
DN40	90	1/8"	106	55	225	258	20.6	182	30	38.1	1.65
	63	1/8"	75	41	187	228					
	90	1/8"	106	55	235	270					
DN50	90	1/8"	106	55	235	270	55.7	210	30	50.8	1.65
	125AL	1/4"	170	85	300	325					
DN65 Square Bonnet	90	1/8"	106	55	286	297	71.6	230	26	63.5	1.65
DN80 Square Bonnet	125AL	1/4"	170	85	338	337	105.2	310	26	76.2	1.65
DN80 Square Bonnet	125AL	1/4"	170	85	355	380	105.2	310	26	76.2	1.65

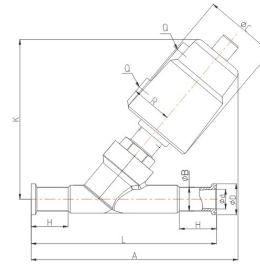

Tri-clamp Connection

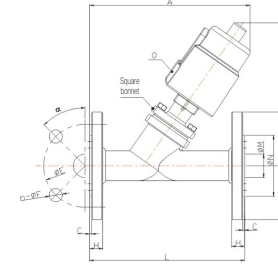

Flange connection

Main Dimension (Tri-clamp Connection)

Size	Actuator (mm)	Q	φC	R	K	A	Kv (m ³ /h)	L	ASME BPE			
									φD	φB	φd	H
DN15	28	1/8"	42	21	112	145	1.3	130	25	12.7	9.4	30
	40	1/8"	50.5	27	127	158	1.7					
	50	1/8"	60	33	140	169	1.7					
DN20	50	1/8"	60	33	138	172	5.8	150	25	19.05	15.75	30
	50	1/8"	60	33	146	180	5.8					
DN25	63	1/8"	75	41	169	205	11.8	160	50.5	25.4	22.1	30
	63	1/8"	75	41	177	225	11.8					
	90	1/8"	106	55	225	267	11.8					
DN40	63	1/8"	75	41	177	225	20.6	200	50.5	38.1	34.8	30
	90	1/8"	106	55	225	267						
	63	1/8"	75	41	187	238						
DN50	90	1/8"	106	55	235	280	55.7	230	64	50.8	47.5	30
	125AL	1/4"	170	85	300	335						
	90	1/8"	106	55	286	327						
DN65 Square bonnet	125AL	1/4"	170	85	337	368	71.6	290	77.4	63.5	60.2	26
DN80 Square bonnet	125AL	1/4"	170	85	349	383	105.2	315	91	76.2	72.9	26

Main Dimension (Flange Connection)

Size	Actuator (mm)	Q	A	B	Kv (m ³ /h)	L	C	H	φE	n-φF	φM	φN	φP	α
DN20 Square bonnet	50	1/8"	145	140	7.6	150	2	14	75	4-14	19	56	105	45°
DN25 Square bonnet	50	1/8"	170	145	15.8	160	2	14	85	4-14	26	65	115	45°
	63	1/8"	190	175	26.0	180	2	16	100	4-18	31	78	140	45°
DN40 Square bonnet	63	1/8"	206	190	32.0	200	3	16	110	4-18	38	84	150	45°
	90	1/8"	250	240	52.0	230	3	16	125	4-18	54	100	165	45°
	63	1/8"	235	195	52.0	230	3	16	125	4-18	54	100	165	45°
DN50 Square bonnet	90	1/8"	277	245	52.0	230	3	16	125	4-18	54	100	165	45°
125AL	1/4"	330	210	52.0	230	3	16	125	4-18	54	100	165	45°	

Flange specification: JB/T82.1(DN2543/DIN2576/EN1092-1/HG20592); ISO/DIN/JS customization available