

204 Series
Flanged Shuttle Valve

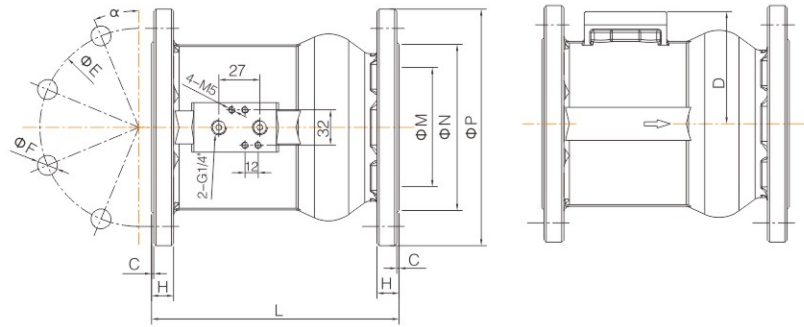

Technical Specification

- Operating pressure: Above seat 0–16bar (0–232psi)
Below seat 0–12bar (0–174psi)
- Control pressure: 3–5bar (43.5–72.5psi)
- Control fluid: Filtered compressed air or neutral gas
- Body material: CF8
- Seal material: EPDM/(FKM can be customized)
- Applicable medium: EPDM–Suitable for steam and hot water,
unsuitable for oils, greases, fuels, etc.
FKM–Suitable for most fluid, except for steam.
- Fluid temperature: –20°C — +130°C (EPDM)
- Ambient temperature: –20°C — +80°C
- Control type: Double acting
- Connection type: Flange
DIN2543/DIN2576/EN1092–1/HG20592
- Leakage class: DIN EN 12266 Class A

Main Dimension

Size	D	L	ϕE	ϕF	H	C	ϕM	ϕN	ϕP	α	Flow value Kv(m ³ /h)	Weight (kg)
DN65	85	192	145	4–ϕ 18	20	2	66	120	180	45°	139.3	10.0
DN80	92	212	160	8–ϕ 18	22	2	75	135	195	22.5°	202.6	13.32
DN100	102	227	180	8–ϕ 18	22	2	94	155	215	22.5°	288	16.30

Order Instruction

